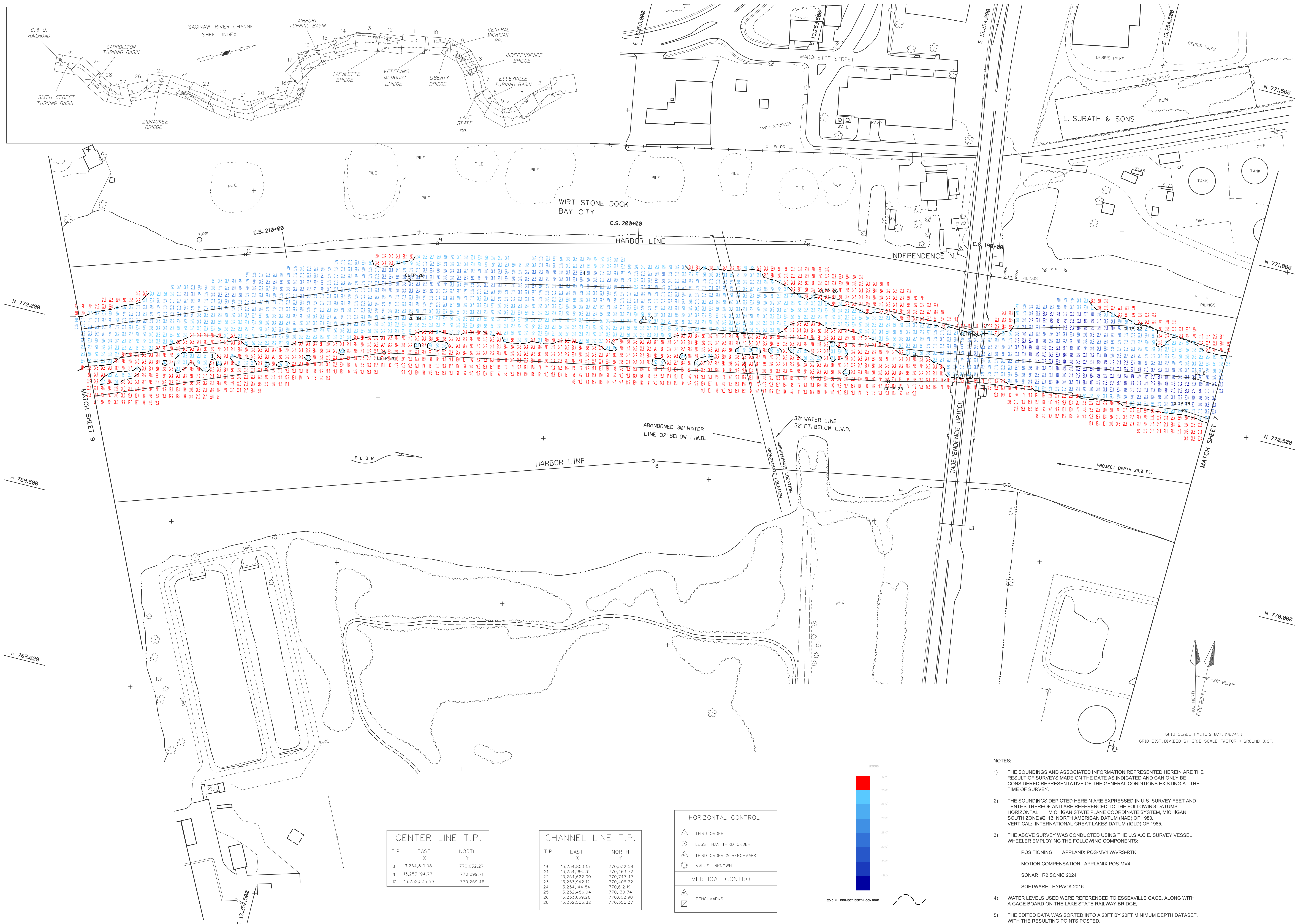

US Army Corps  
of Engineers®

## NOTES:

- 1) THE SOUNDINGS AND ASSOCIATED INFORMATION REPRESENTED HEREIN ARE THE RESULT OF SURVEYS MADE ON THE DATE AS INDICATED AND CAN ONLY BE CONSIDERED REPRESENTATIVE OF THE GENERAL CONDITIONS EXISTING AT THE TIME OF SURVEY.
- 2) THE SOUNDINGS DEPICTED HEREIN ARE EXPRESSED IN U.S. SURVEY FEET AND TENTHS THEREOF AND ARE REFERENCED TO THE FOLLOWING DATUMS:  
HORIZONTAL: MICHIGAN STATE PLANE COORDINATE SYSTEM, MICHIGAN SOUTH ZONE #213, NORTH AMERICAN DATUM (NAD) OF 1983.  
VERTICAL: INTERNATIONAL GREAT LAKES DATUM (IGLD) OF 1985.
- 3) THE ABOVE SURVEY WAS CONDUCTED USING THE U.S.A.C.E. SURVEY VESSEL WHEELER EMPLOYING THE FOLLOWING COMPONENTS:  
POSITIONING: APPLANIX POS-MV4 WIVRS-RTK  
MOTION COMPENSATION: APPLANIX POS-MV4  
SONAR: R2 SONIC 2024  
SOFTWARE: HYPACK 2016
- 4) WATER LEVELS USED WERE REFERENCED TO ESSEXVILLE GAGE, ALONG WITH A GAGE BOARD ON THE LAKE STATE RAILWAY BRIDGE.
- 5) THE EDITED DATA WAS SORTED INTO A 20FT BY 20FT MINIMUM DEPTH DATASET, WITH THE RESULTING POINTS POSTED.

HORIZONTAL CONTROL	
△	THIRD ORDER
○	LESS THAN THIRD ORDER
△	THIRD ORDER & BENCHMARK
○	VALUE UNKNOWN
VERTICAL CONTROL	
△	BENCHMARKS

CENTER LINE T.P.		
T.P.	EAST X	NORTH Y
8	13,254,810.98	770,632.27
9	13,253,194.77	770,399.71
10	13,252,535.59	770,259.46

CHANNEL LINE T.P.		
T.P.	EAST X	NORTH Y
19	13,254,803.13	770,532.58
21	13,254,166.20	770,463.72
22	13,254,622.00	770,747.57
23	13,253,942.12	770,406.22
24	13,254,144.84	770,610.19
25	13,252,486.04	770,130.74
26	13,253,669.28	770,602.90
28	13,252,505.82	770,355.37

DESIGNED BY:  
U.S. ARMY CORPS OF ENGINEERS  
DETROIT DISTRICT  
311 MARQUETTE  
DETROIT, MI 48226

DRAWN BY:  
SUBMITTED BY:  
CHECKED BY:  
FILE NAME:  
FILE NUMBER:  
DATE:  
SCALE:

DESIGNED BY:  
U.S. ARMY CORPS OF ENGINEERS  
DETROIT DISTRICT  
311 MARQUETTE  
DETROIT, MI 48226

DRAWN BY:  
SUBMITTED BY:  
CHECKED BY:  
FILE NAME:  
FILE NUMBER:  
DATE:  
SCALE:

SAGINAW RIVER  
MICHIGAN  
POST-BRIDGE SURVEY  
07 AUG 2018

SHEET  
IDENTIFICATION