US Army Corps
of Engineers

E

D

C

B

A

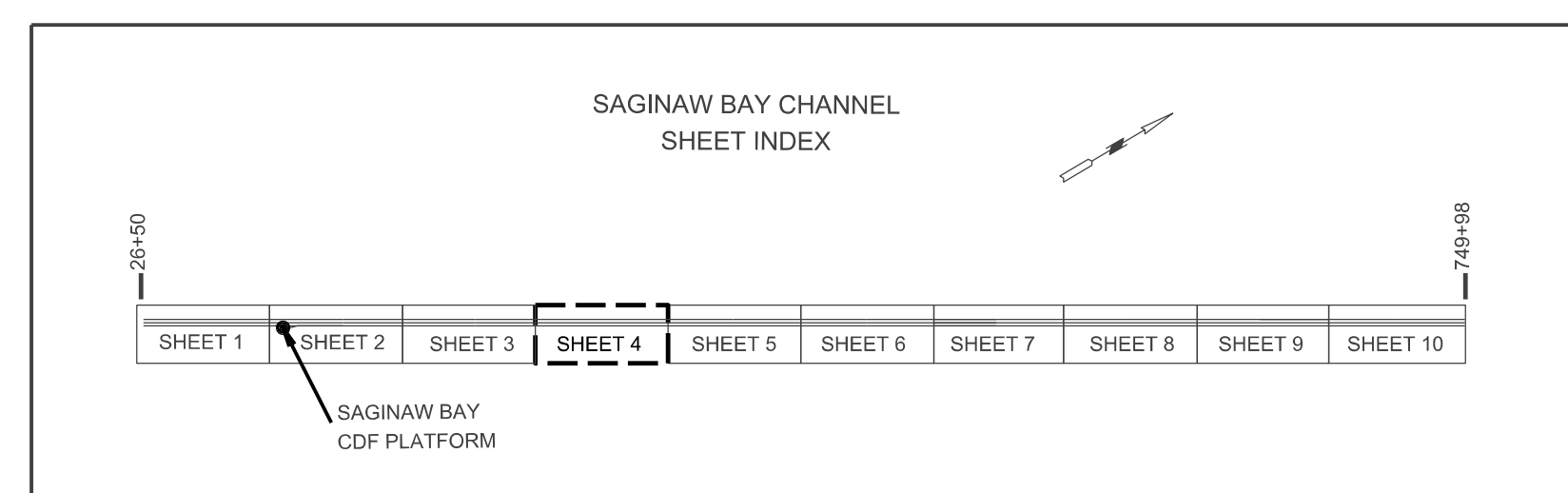
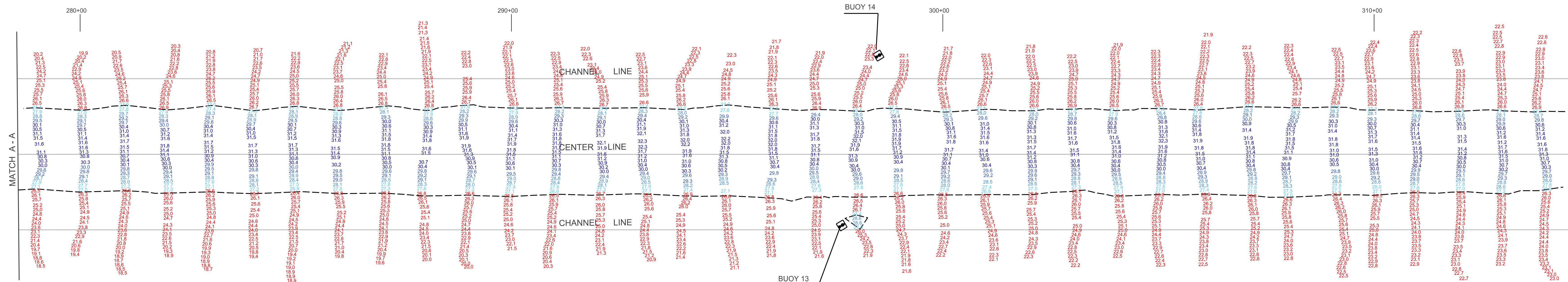
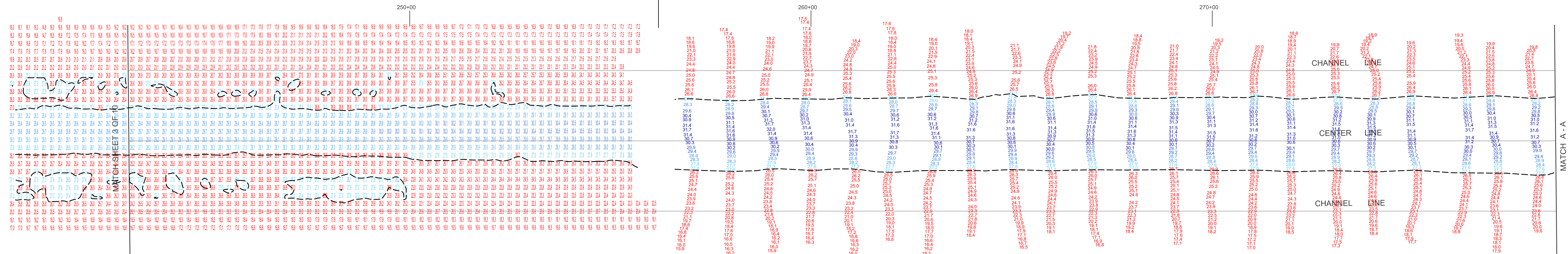
SURVEY DATES
POST-DREDGE SURVEY
07 AUG 2018
CONDITION SURVEY
02 NOV 2017

NOTES:

- 1) THE SOUNDINGS AND ASSOCIATED INFORMATION REPRESENTED HEREIN ARE THE RESULT OF SURVEYS MADE ON THE DATE AS INDICATED AND CAN ONLY BE CONSIDERED REPRESENTATIVE OF THE GENERAL CONDITIONS EXISTING AT THE TIME OF SURVEY.
- 2) THE SOUNDINGS DEPICTED HEREIN ARE EXPRESSED IN U.S. SURVEY FEET AND TENTHS THEREOF AND ARE REFERENCED TO THE FOLLOWING DATUMS:
HORIZONTAL: MICHIGAN STATE PLANE COORDINATE SYSTEM, MICHIGAN SOUTH ZONE #2113, NORTH AMERICAN DATUM (NAD) OF 1983.
VERTICAL: INTERNATIONAL GREAT LAKES DATUM (IGLD) OF 1985.
- 3) THE ABOVE SURVEY WAS CONDUCTED USING THE U.S.A.C.E. SURVEY VESSEL WHEELER EMPLOYING THE FOLLOWING COMPONENTS:
POSITIONING: APPLANIX POS-MV4 WYRS-RTK
MOTION COMPENSATION: APPLANIX POS-MV4
SONAR: R2 SONIC 2024
SOFTWARE: HYPACK 2016
- 4) TIDE CORRECTION VALUES DERIVED FROM THE NOAA WATER LEVEL STATION(S) AS FOLLOWS: ESSEXVILLE, MI (#9075035); L.W.D. = 577.50.
- 5) THE EDITED DATA WAS SORTED INTO A 20FT BY 20FT MINIMUM DEPTH DATASET, WITH THE RESULTING POINTS POSTED.

202 PROJECT DEPTH

27.0 IL PROJECT DEPTH CONTOUR

SCALE 1" = 100'

DESIGNED BY: U.S. ARMY CORPS OF ENGINEERS
DRAWN BY: DETROIT DISTRICT
SUBMITTED BY: DETROIT DISTRICT
FILE NUMBER: 6090 WEST JEFFERSON AVE
DETROIT, MI 48209

SAGINAW BAY
MICHIGAN
POST-DREDGE SURVEY
07 AUG 2018

SHEET
IDENTIFICATION

SHEET 4 OF 10