



US Army Corps
of Engineers

| | |
|---|-----------------------|
| PROJECT NAME: SAGINAW RIVER CHANNEL SHEET INDEX | DATE: 20 JULY 2019 |
| DESIGNED BY: DETROIT DISTRICT DETROIT, MI 48226 | DATE: 20 JULY 2019 |
| DRAWN BY: SUBMITTED BY: CHECKED BY: IN CHARGE: | DATE: 20 JULY 2019 |
| CONTRACT NO.: | DATE: 20 JULY 2019 |
| FILE NUMBER: | DATE: 20 JULY 2019 |
| PROJECT NAME: | DATE: 20 JULY 2019 |

SAGINAW RIVER
MICHIGAN
POST OFFICE SURVEY
20 JULY 2019

SHEET
IDENTIFICATION

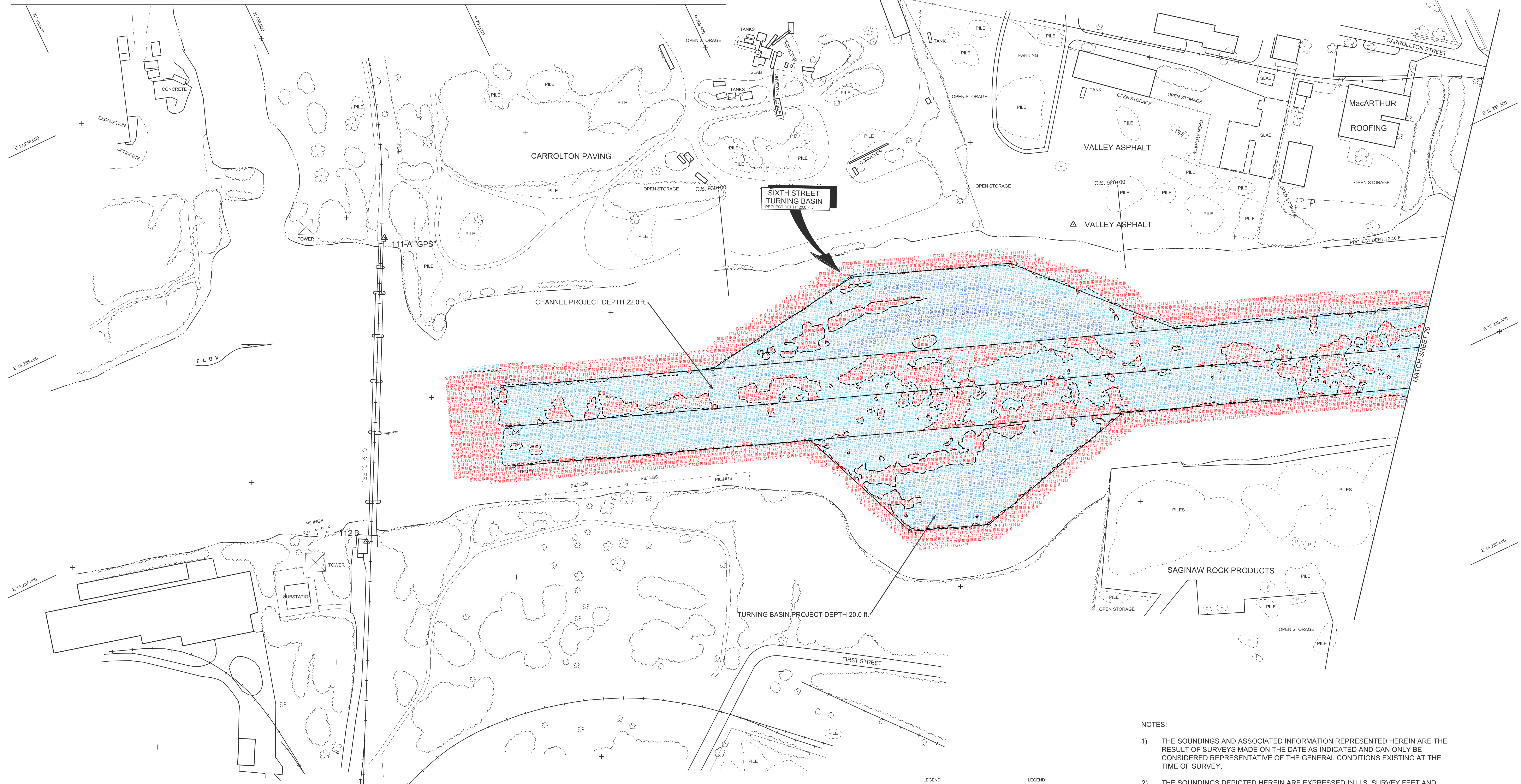
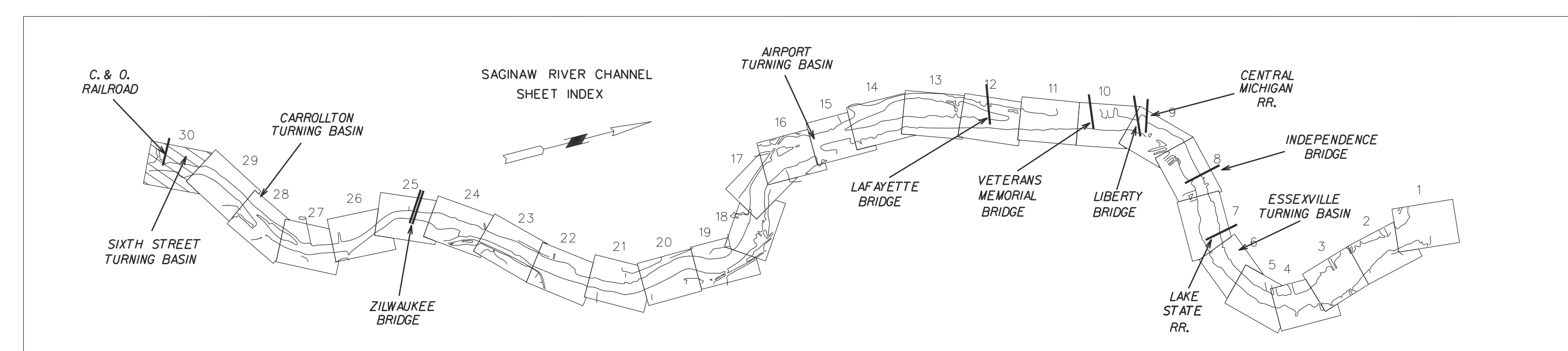

| CHANNEL LINE T.P. | | | |
|-------------------|---------------|------------|--|
| T.P. | EAST X | NORTH Y | |
| 111 | 13,237,244.76 | 708,613.33 | |
| 116 | 13,237,262.90 | 708,670.90 | |

| TURNING BASIN T.P. | | | |
|--------------------|---------------|------------|--|
| T.P. | EAST X | NORTH Y | |
| 1 | 13,237,645.00 | 710,266.78 | |
| 2 | 13,237,318.36 | 709,991.39 | |
| 3 | 13,237,179.22 | 709,586.40 | |
| 4 | 13,237,237.99 | 709,169.96 | |
| 5 | 13,237,505.50 | 709,316.00 | |
| 6 | 13,237,819.88 | 708,444.64 | |
| 7 | 13,237,889.45 | 709,632.13 | |
| 8 | 13,237,779.59 | 710,054.61 | |

| HORIZONTAL CONTROL | |
|--------------------|-------------------------|
| △ | THIRD ORDER |
| ○ | LESS THAN THIRD ORDER |
| △ | THIRD ORDER & BENCHMARK |
| ○ | VALUE UNKNOWN |
| VERTICAL CONTROL | |
| △ | BENCHMARKS |

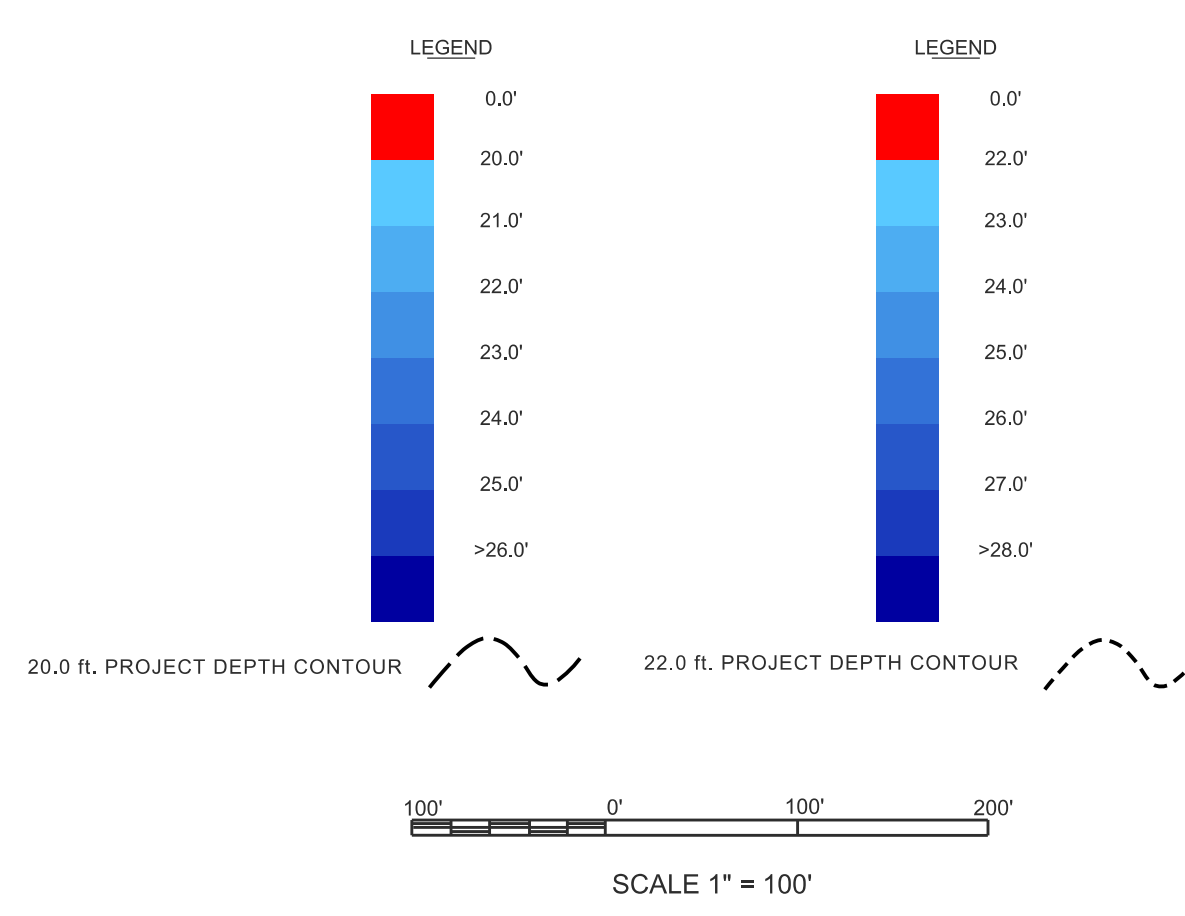

- NOTES:
- THE SOUNDINGS AND ASSOCIATED INFORMATION REPRESENTED HEREIN ARE THE RESULT OF SURVEYS MADE ON THE DATE AS INDICATED AND CAN ONLY BE CONSIDERED REPRESENTATIVE OF THE GENERAL CONDITIONS EXISTING AT THE TIME OF SURVEY.
 - THE SOUNDINGS DEPICTED HEREIN ARE EXPRESSED IN U.S. SURVEY FEET AND TENTHS THEREOF AND ARE REFERENCED TO THE FOLLOWING DATUMS:
HORIZONTAL: MICHIGAN STATE PLANE COORDINATE SYSTEM, MICHIGAN SOUTH ZONE #2113, NORTH AMERICAN DATUM (NAD) OF 1983.
VERTICAL: INTERNATIONAL GREAT LAKES DATUM (IGLD) OF 1985.
L.W.D. = 577.5' UNLESS OTHERWISE NOTED.
 - THE ABOVE SURVEY WAS CONDUCTED USING THE U.S.A.C.E. SURVEY VESSEL WHEELER EMPLOYING THE FOLLOWING COMPONENTS:
POSITIONING: APPLANIX POS-MV4 W/VRS-RTK OR MARINESTAR G2+
MOTION COMPENSATION: APPLANIX POS-MV4
SONAR: R2 SONIC 2024
SOFTWARE: HYPACK 2018
 - WATER LEVELS USED WERE REFERENCED TO TBM FARM BUREAU.
 - THE SOUNDINGS INDICATED HEREON ARE GENERALIZED DEPTHS AND ARE NOT REPRESENTATIVE OF THE FULL DATASET. THE SOUNDINGS REPRESENT THE MINIMUM DEPTH FOUND WITHIN THE 10 FOOT BY 10 FOOT AVERAGE DATASET AT CELL CENTER. THIS MAP SHOULD NOT BE USED FOR CHANNEL CLEARANCE OR VOLUME COMPUTATIONS. MINIMUM DEPTH DATA IS PRODUCED FOR STRIKE/SOAL REMOVAL OPERATIONS AND NOTICES TO NAVIGATION INTERESTS.