

230+00

240+00

250+00

260+00

265+00

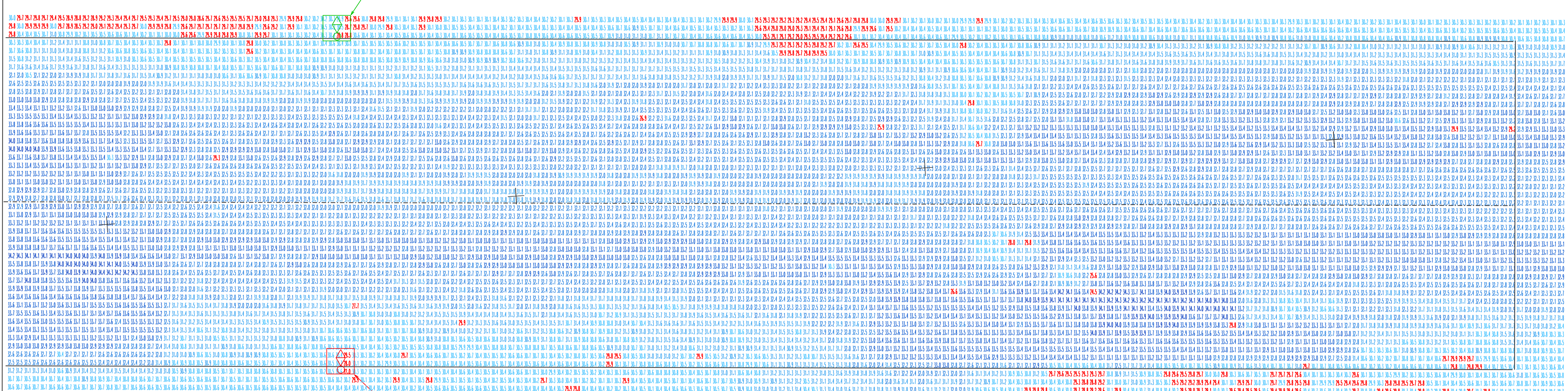

L.W.D. 577.4' PROJECT DEPTH 30.0 FT.

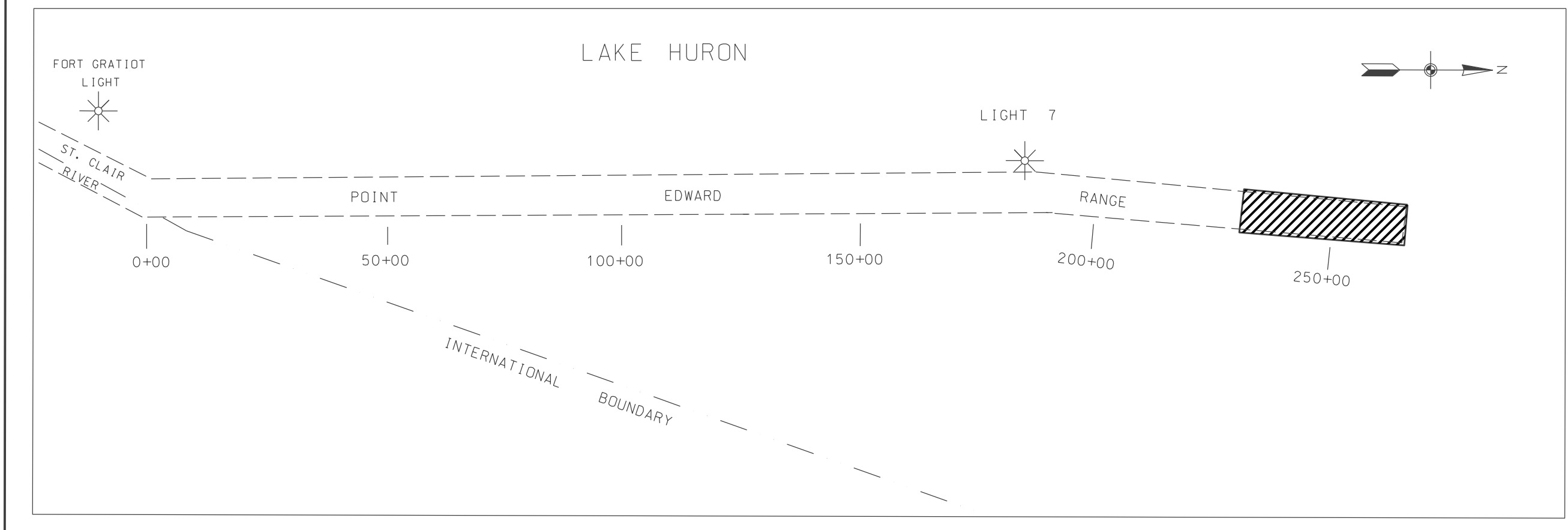
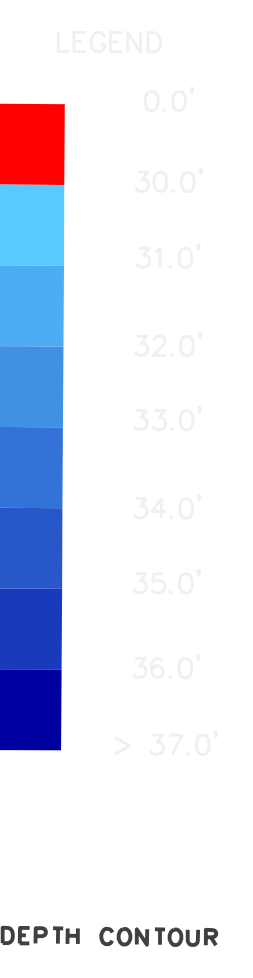

- NOTES:
- 1) THE SOUNDINGS AND ASSOCIATED INFORMATION REPRESENTED HEREIN ARE THE RESULT OF SURVEYS MADE ON THE DATE AS INDICATED AND CAN ONLY BE CONSIDERED REPRESENTATIVE OF THE GENERAL CONDITIONS EXISTING AT THE TIME OF SURVEY.
  - 2) THE SOUNDINGS DEPICTED HEREIN ARE EXPRESSED IN U.S. SURVEY FEET AND TENTHS THEREOF AND ARE REFERENCED TO THE FOLLOWING DATUMS:  
HORIZONTAL: MICHIGAN STATE PLANE, COORDINATE SYSTEM, MICHIGAN SOUTH ZONE #213, NORTH AMERICAN DATUM (NAD) OF 1983.  
VERTICAL: INTERNATIONAL GREAT LAKES DATUM (IGLD) OF 1985.
  - 3) THE ABOVE SURVEY WAS CONDUCTED USING THE U.S.A.C.E. SURVEY VESSEL WHEELER EMPLOYING THE FOLLOWING COMPONENTS:  
POSITIONING: APPLINX POS-MV4 W/DOGS CORRECTIONS, U.S.C.G. BEACON #838  
MOTION COMPENSATION: APPLINX POS-MV4  
SONAR: R2SONIC 2024 (MULTIBEAM TRANSDUCER)  
SOFTWARE: HYPACK 2015
  - 4) TIDE CORRECTION VALUES DERIVED FROM THE NATIONAL OCEANIC AND ATMOSPHERIC ADMINISTRATION (NOAA) WATER LEVEL STATION(S) AS FOLLOWS:  
FORT GRATIOT GAUGE, FORT GRATIOT, MI NOAA STATION ID (#9014098)
  - 5) THE EDITED MULTIBEAM DATA WAS SORTED INTO A 20 FT. BY 20 FT. MATRIX WHERE THE AVERAGE MINIMUM SOUNDING WAS SELECTED FOR PLOTTING AT THE CELL CENTER.

	UNITED STATES ARMY CORPS OF ENGINEERS DETROIT AREA OFFICE, DETROIT, MICHIGAN	
	EXISTING CONDITIONS POINT EDWARD RANGE LAKE HURON, MI CS 230+00 TO CS 265+00	
DRAWN BY: J.K.P. CHECKED BY: C.V.L.	DATE OF SURVEY: 20 OCTOBER 2015	<p>SCALE 1" = 100'</p>
		SHEET 8 OF 8