

251+00 260+00 270+00 280+00 288+00

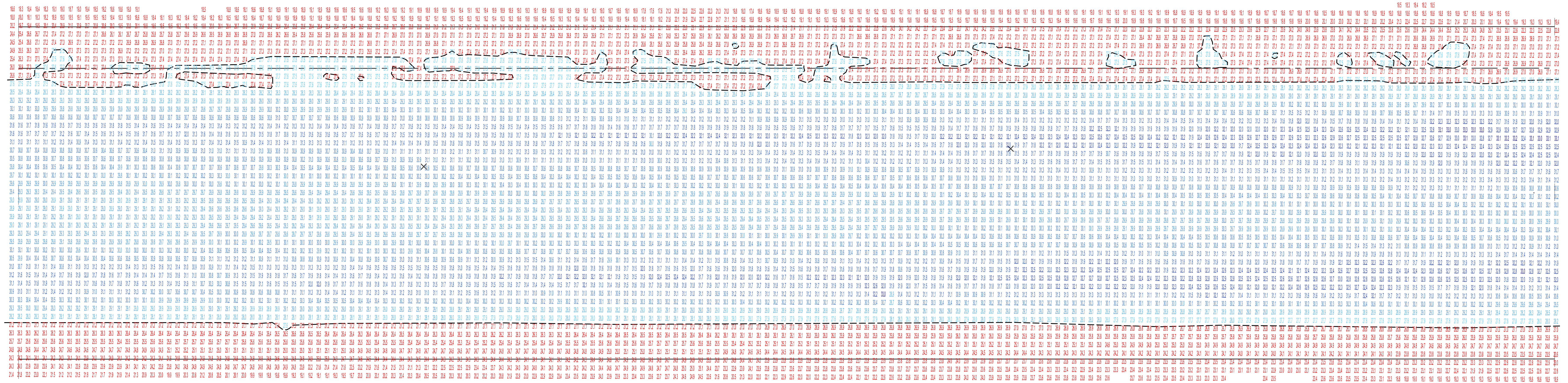

L.W.D. 572.3'

PROJECT DEPTH 27.5 FT.
C.L. AZ = 46°-43'-45.2"

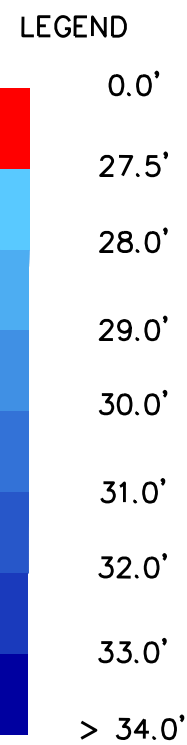

27.5 ft. PROJECT DEPTH CONTOUR

- NOTES:
- 1) THE SOUNDINGS AND ASSOCIATED INFORMATION REPRESENTED HEREIN ARE THE RESULT OF SURVEYS MADE ON THE DATE AS INDICATED AND CAN ONLY BE CONSIDERED REPRESENTATIVE OF THE GENERAL CONDITIONS EXISTING AT THE TIME OF SURVEY.
 - 2) THE SOUNDINGS DEPICTED HEREIN ARE EXPRESSED IN U.S. SURVEY FEET AND TENTHS THEREOF AND ARE REFERENCED TO THE FOLLOWING DATUMS:
HORIZONTAL: MICHIGAN STATE PLANE, COORDINATE SYSTEM, MICHIGAN SOUTH ZONE #2113, NORTH AMERICAN DATUM (NAD) OF 1983
VERTICAL: INTERNATIONAL GREAT LAKES DATUM (IGLD) OF 1985.
 - 3) THE ABOVE SURVEY WAS CONDUCTED USING THE U.S.A.C.E. SURVEY VESSEL WHEELER EMPLOYING THE FOLLOWING COMPONENTS:
POSITIONING: APPLANIX POS-MV4 W/DGPS CORRECTIONS, U.S.C.G. BEACON #838
MOTION COMPENSATION: APPLANIX POS-MV4
SONAR: EPOSonic 2024 (MULTIBEAM TRANSDUCER)
SOFTWARE: HYPACK 2015
 - 4) TIDE CORRECTION VALUES DERIVED FROM THE NATIONAL OCEANIC AND ATMOSPHERIC ADMINISTRATION (NOAA) WATER LEVEL STATION(S) AS FOLLOWS:
ST CLAIR SHORES, MI (#9034052)
 - 5) THE EDITED MULTIBEAM DATA WAS SORTED INTO A 20 FT. BY 20 FT. MATRIX WHERE THE MINIMUM SOUNDING WAS SELECTED FOR PLOTTING AT THE CELL CENTER.

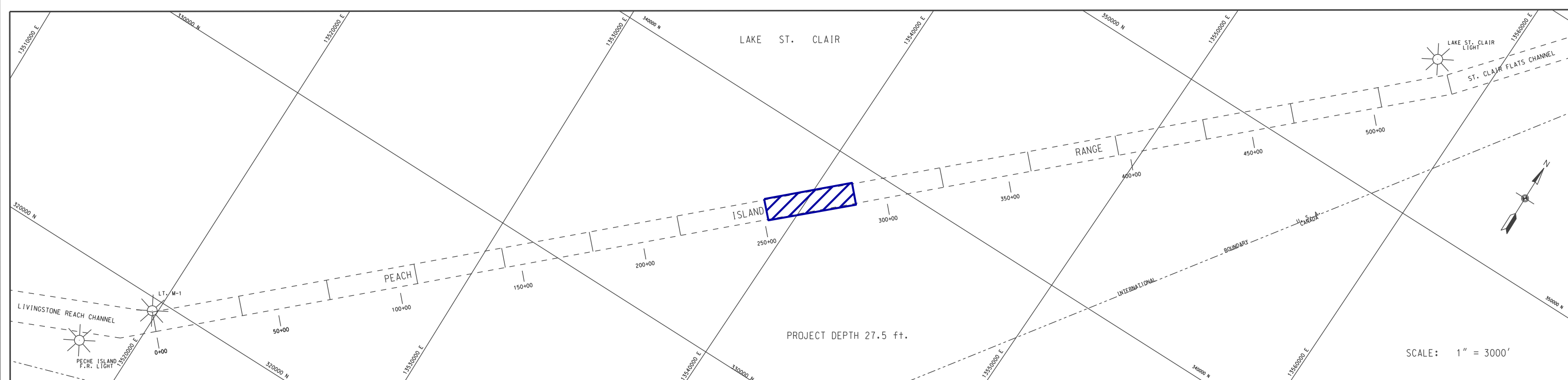

	UNITED STATES ARMY CORPS OF ENGINEERS DETROIT AREA OFFICE, DETROIT, MICHIGAN	
	EXISTING CONDITIONS PECHE ISLAND RANGE LAKE ST CLAIR, MI CS 251+00 TO CS 288+00	
DRAWN BY: B.R.	DATE OF SURVEY: 21 SEP 2017	
CHECKED BY: C.V.L.	SCALE 1" = 100'	
		SHEET 8 OF 15