

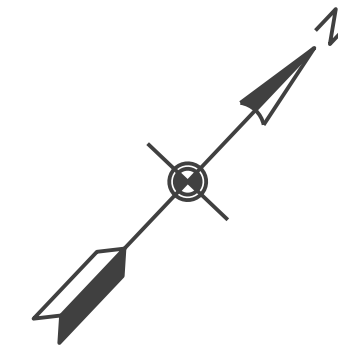

13525000
N 325500



13527000
N 327000

72+00

80+00

90+00

100+00

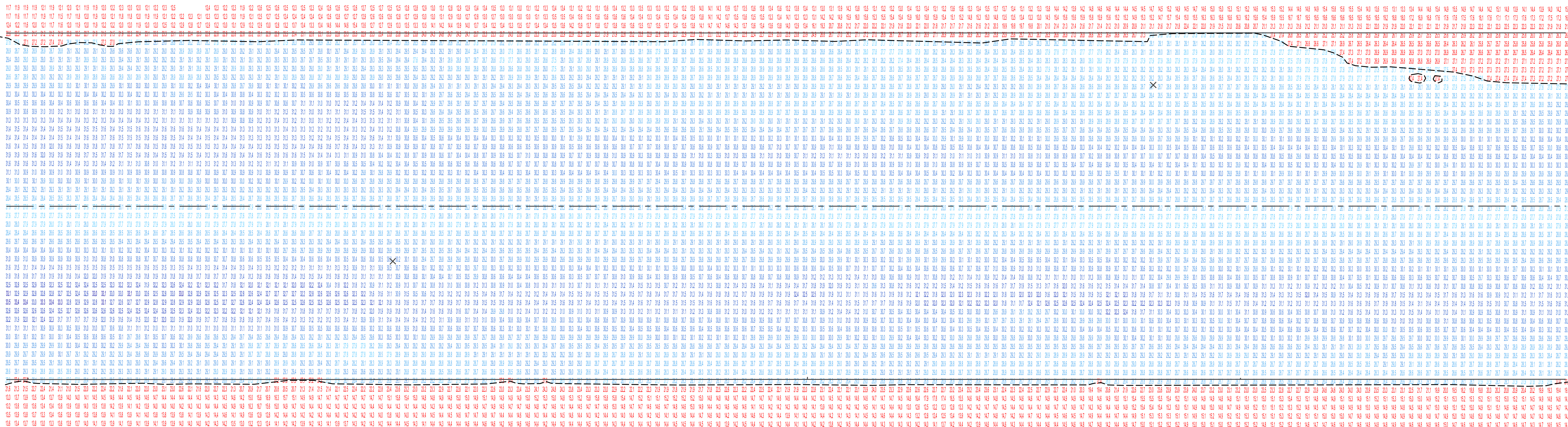

PROJECT DEPTH 27.5 FT.
C.L. AZ = 46-43'-45.2"

L.W.D. 572.3'

LEGEND

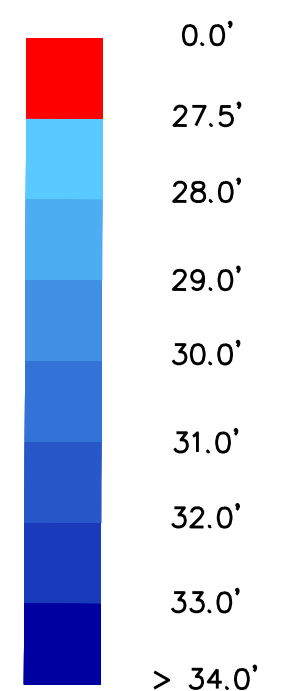

27.5 ft. PROJECT DEPTH CONTOUR

NOTES:

- THE SOUNDINGS AND ASSOCIATED INFORMATION REPRESENTED HEREIN ARE THE RESULT OF SURVEYS MADE ON THE DATE AS INDICATED AND CAN ONLY BE CONSIDERED REPRESENTATIVE OF THE GENERAL CONDITIONS EXISTING AT THE TIME OF SURVEY.
- THE SOUNDINGS DEPICTED HEREIN ARE EXPRESSED IN U.S. SURVEY FEET AND TENTHS THEREOF AND ARE REFERENCED TO THE FOLLOWING DATUMS:
HORIZONTAL: MICHIGAN STATE PLANE COORDINATE SYSTEM, MICHIGAN SOUTH ZONE #2113, NORTH AMERICAN DATUM (NAD) OF 1983.
VERTICAL: INTERNATIONAL GREAT LAKES DATUM (IGLD) OF 1985.
- THE ABOVE SURVEY WAS CONDUCTED USING THE U.S.A.C.E. SURVEY VESSEL WHEELER EMPLOYING THE FOLLOWING COMPONENTS:
POSITIONING: APPLINX POS-MV4 W/DPDS CORRECTIONS, U.S.C.G. BEACON #938
MOTION COMPENSATION: APPLINX POS-MV4
SONAR: R2SONIC 2024 (MULTIBEAM TRANSDUCER)
SOFTWARE: HYPACK 2015
- TIDE CORRECTION VALUES DERIVED FROM THE NATIONAL OCEANIC AND ATMOSPHERIC ADMINISTRATION (NOAA) WATER LEVEL STATION(S) AS FOLLOWS:
ST CLAIR GAUGE, MI (#9034052)
- THE EDITED MULTIBEAM DATA WAS SORTED INTO A 20 FT. BY 20 FT. MATRIX WHERE THE MINIMUM SOUNDING WAS SELECTED FOR PLOTTING AT THE CELL CENTER.

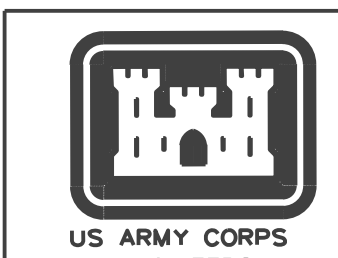
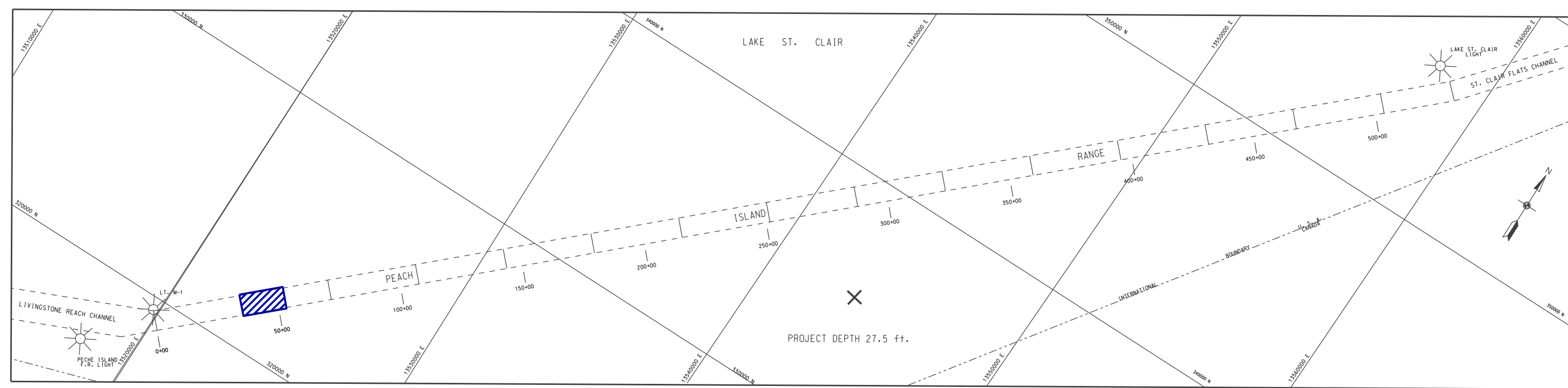

DRAWN BY: B.R.

CHECKED BY: C.V.L.

UNITED STATES ARMY CORPS OF ENGINEERS
DETROIT AREA OFFICE, DETROIT, MICHIGAN

EXISTING CONDITIONS
PECHE ISLAND RANGE
LAKE ST CLAIR, MI
CS 72+00 TO CS 107+00

DATE OF SURVEY: 24 AUGUST 2017

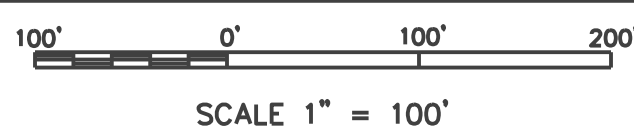

SCALE 1" = 100'

SHEET 3 of 15