

1

2

3

4

5

6

E

D

C

B

A

13553600
N 352000

470+00

480+00

490+00

500+00

504+00

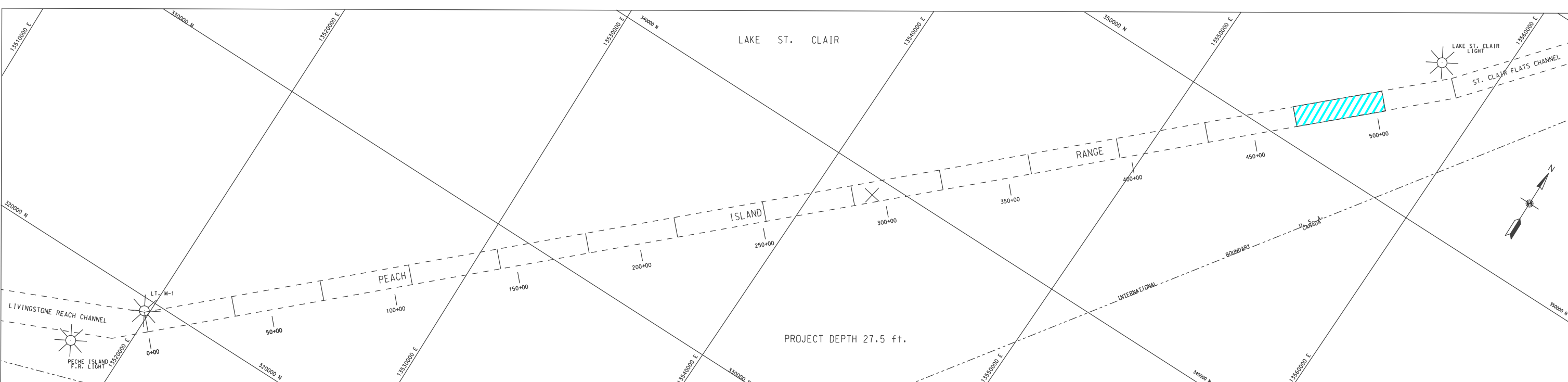
E 12550000
N 352000E 12557000
N 352000

L.W.D. 572.3'
PROJECT DEPTH 27.5 FT.
C.L. AZ = 46 - 43' - 45.2'

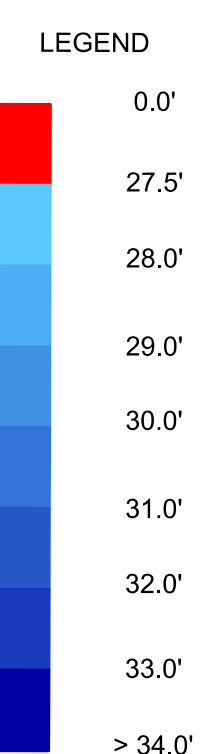

27.5' PROJECT CONTOUR

NOTES:

- THE SOUNDINGS INDICATED HEREON ARE GENERALIZED DEPTHS AND ARE NOT REPRESENTATIVE OF THE FULL DATASET. THE SOUNDINGS REPRESENT THE MINIMUM DEPTH FOUND WITHIN THE 10 FOOT BY 10 FOOT AREA CENTERED ON THE TEXT, DERIVED FROM A 1 FOOT BY 1 FOOT AVERAGE DATASET AT CELL CENTER. THIS MAP SHOULD NOT BE USED FOR CHANNEL CLEARANCE OR VOLUME COMPUTATIONS. MINIMUM DEPTH DATA IS PRODUCED FOR STRIKE/SOAL REMOVAL OPERATIONS AND NOTICES TO NAVIGATION INTERESTS.
- THE SOUNDINGS DEPICTED HEREIN ARE EXPRESSED IN U.S. SURVEY FEET AND TENTHS THEREOF AND ARE REFERENCED TO THE FOLLOWING DATUMS:
HORIZONTAL: MICHIGAN STATE PLANE COORDINATE SYSTEM, MICHIGAN SOUTH ZONE #213, NORTH AMERICAN DATUM (NAD) OF 1983.
VERTICAL: INTERNATIONAL GREAT LAKES DATUM (IGLD) OF 1985.
- THE ABOVE SURVEY WAS CONDUCTED USING THE U.S.A.C.E. SURVEY VESSEL WHEELER EMPLOYING THE FOLLOWING COMPONENTS:
POSITIONING: APPLANIX POS-MV4 WIMARINERSTAR G2+ CORRECTIONS
MOTION COMPENSATION: APPLANIX POS-MV4
SONAR: H2SONIC 2024 (MULTIBEAM TRANSDUCER)
SOFTWARE: HYPACK 2018
- TIDE CORRECTION VALUES DERIVED FROM THE NATIONAL OCEANIC AND ATMOSPHERIC ADMINISTRATION (NOAA) WATER LEVEL STATION(S) AS FOLLOWS:
LAKE ST CLAIR GAUGE, LAKE ST CLAIR, MI (#9034052)

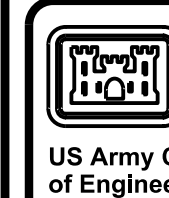
US Army Corps
of EngineersU.S. ARMY CORPS OF ENGINEERS
DETROIT DISTRICT
DETROIT, MI 48226DETROIT AREA OFFICE
6309 WEST JEFFERSON AVE
DETROIT, MI 48209PECHE ISLAND RANGE
MICHIGANCONDITION OF CHANNEL
18 JULY 2019SHEET
IDENTIFICATION

SHEET 14 OF 15