

E

D

C

B

A



E 10541000  
N 345500

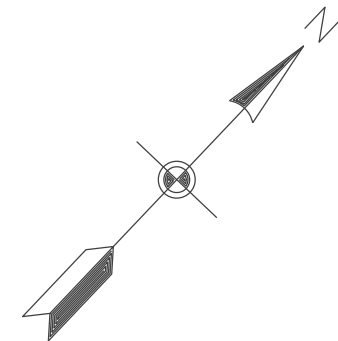

E 10558000  
N 345500

440+00

450+00

460+00

21

22

L.W.D. 572.3'  
PROJECT DEPTH 27.5 FT.  
C.L. AZ = 46° - 43' - 45.2"

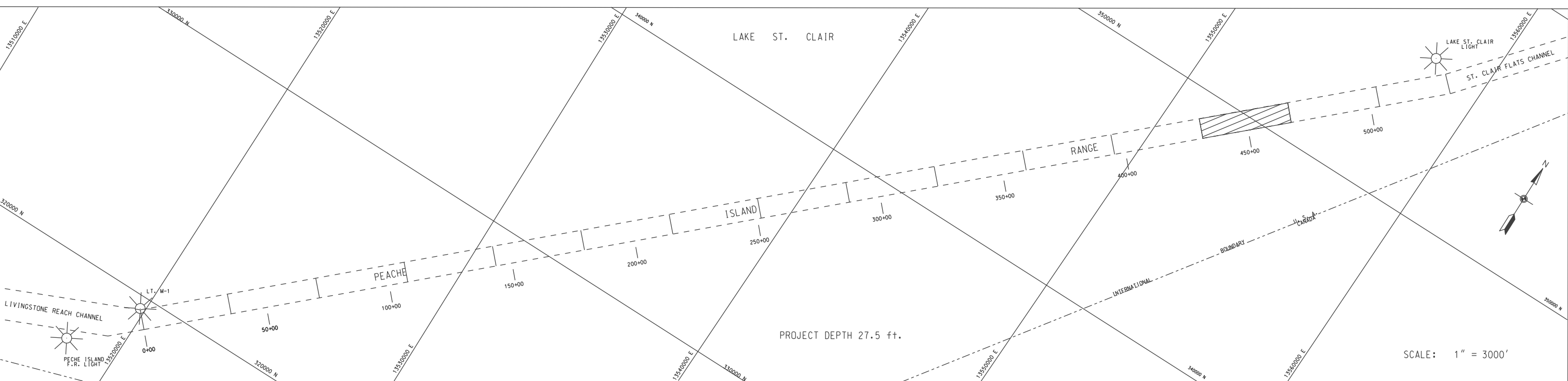

LEGEND



NOTES:

- THE SOUNDINGS INDICATED HEREON ARE GENERALIZED DEPTHS AND ARE NOT REPRESENTATIVE OF THE FULL DATASET. THE SOUNDINGS REPRESENT THE MINIMUM DEPTH FOUND WITHIN THE 10 FOOT BY 10 FOOT AREA CENTERED ON THE TEXT. DERIVED FROM A 1 FOOT BY 1 FOOT AVERAGE DATASET AT CELL CENTER. THIS MAP SHOULD NOT BE USED FOR CHANNEL CLEARANCE OR VOLUME COMPUTATIONS. MINIMUM DEPTH DATA IS PRODUCED FOR STRIKE/SOAL REMOVAL OPERATIONS AND NOTICES TO NAVIGATION INTERESTS.
- THE SOUNDINGS DEPICTED HEREIN ARE EXPRESSED IN U.S. SURVEY FEET AND TENTHS THEREOF AND ARE REFERENCED TO THE FOLLOWING DATUMS:  
HORIZONTAL: MICHIGAN STATE PLANE COORDINATE SYSTEM, MICHIGAN SOUTH ZONE #2113, NORTH AMERICAN DATUM (NAD) OF 1983  
VERTICAL: INTERNATIONAL GREAT LAKES DATUM (IGLD) OF 1985.
- THE ABOVE SURVEY WAS CONDUCTED USING THE U.S.A.C.E. SURVEY VESSEL WHEELER EMPLOYING THE FOLLOWING COMPONENTS:  
POSITIONING: APPLANIX POS-MV4 WIMARINESTAR G2+ CORRECTIONS  
MOTION COMPENSATION: APPLANIX POS-MV4  
SONAR: FSCONIC 2024 (MULTIBEAM TRANSDUCER)  
SOFTWARE: HYPACK 2018
- TIDE CORRECTION VALUES DERIVED FROM THE NATIONAL OCEANIC AND ATMOSPHERIC ADMINISTRATION (NOAA) WATER LEVEL STATION(S) AS FOLLOWS:  
LAKE ST CLAIR GAGE, LAKE ST CLAIR, MI (#9034052)

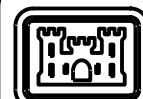

US Army Corps  
of Engineers

U.S. ARMY CORPS OF ENGINEERS  
DETROIT DISTRICT  
DETROIT, MI 48205

NAME OF SURVEY:  
SOUNDING:  
CONTRACT NO.:  
FILE NUMBER:  
FILE NAME:

PECHE ISLAND RANGE  
MICHIGAN

CONDITION OF CHANNEL  
18 JULY 2019

SHEET  
IDENTIFICATION

SHEET 13 OF 15