

US Army Corps of Engineers

U.S. ARMY CORPS OF ENGINEERS
DETROIT DISTRICT
DETROIT, MI

FILE NAME: KWWW08
DRAWN DATE: 11-20-16
FILE NAME: KWWW08
DRAWN DATE: 11-20-16

NEWEANAW WATERWAY
MICHIGAN

CONDITION OF CHANNEL
JUNE 2018

SHEET IDENTIFICATION
KWWW 08

DATE: 11-20-16
SCALE: AS SHOWN
DESCRIPTION: CHANNEL

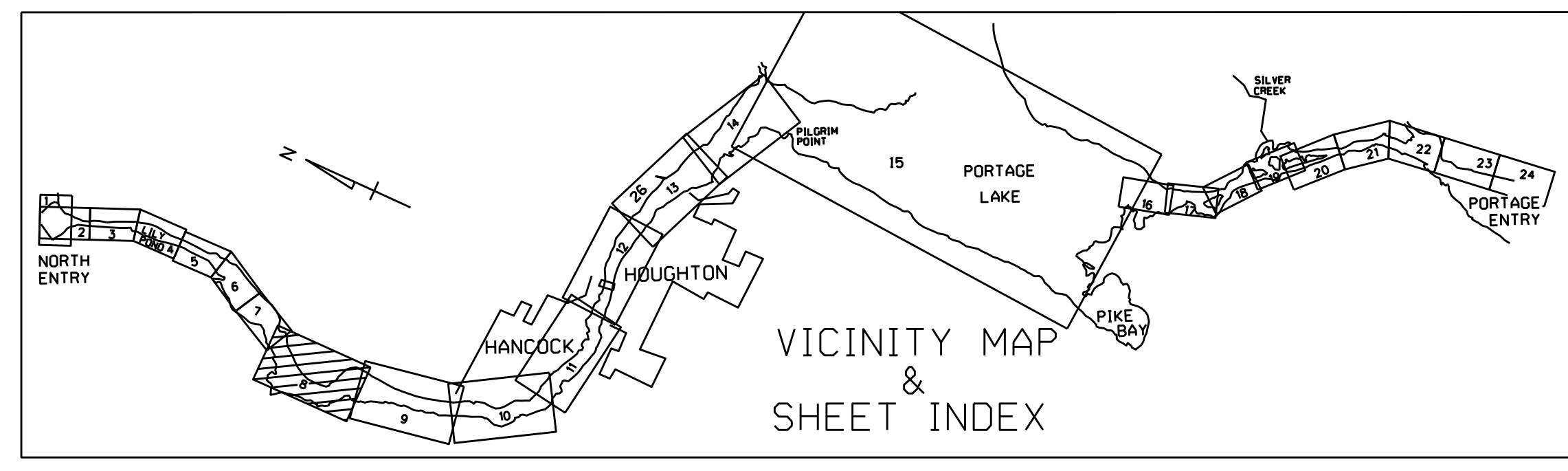
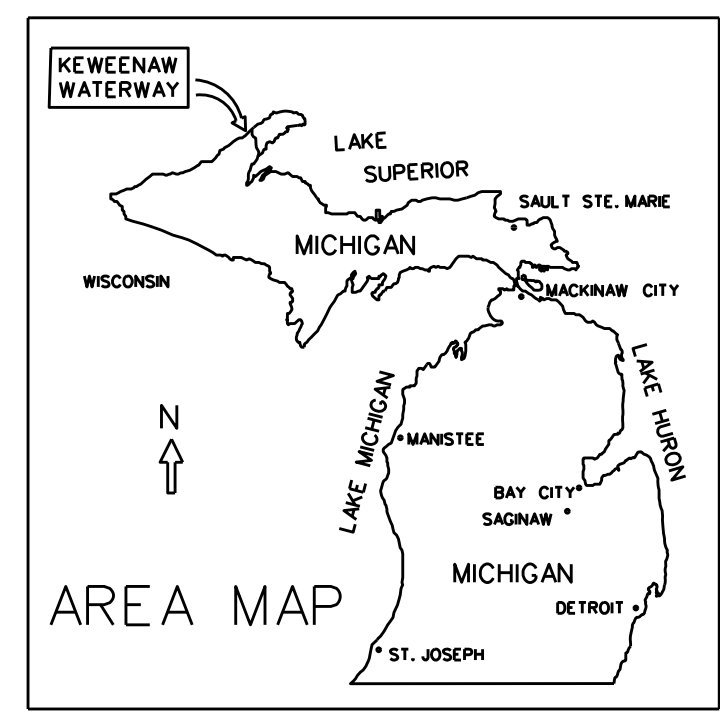

- NOTES**
1. THE INFORMATION DEPICTED ON THIS MAP REPRESENTS THE RESULTS OF SURVEYS MADE ON JUNE 08, 2018 AND CAN ONLY BE CONSIDERED AS INDICATING THE GENERAL CONDITIONS PRESENT AT THE TIME.
 2. SOUNDING DEPTHS ARE REFERENCED TO INTERNATIONAL GREAT LAKES DATUM 1985 (IGLD 85) LOW WATER DATUM (LWD) ELEVATION IS 601.1 FEET ABOVE MEAN WATER LEVEL AT RICOUSI QUEBEC. WATER LEVEL READINGS WERE OBTAINED WITH RTK GPS VALUES. DEPTHS ARE MEASURED USING A ROSS 825B SINGLE BEAM DEPTH SOUNDER.
 3. HORIZONTAL POSITIONING IS DETERMINED USING REAL TIME KINEMATIC (RTK) GLOBAL NAVIGATION SATELLITE SYSTEM (GNSS) CORRECTIONS FROM A BASE STATION LOCATED AT US ARMY CORPS OF ENGINEERS (USACE) CONTROL POINT 103. A BRASS DISK STAMPED "NEWMAN 1991" SET IN CONCRETE AT THE BASE OF NAVIGATION AID NUMBER 69 AT THE END OF A PIER, ON THE SOUTH EAST SIDE OF LILY POND. THE GPS RECEIVER IS MANUFACTURED BY APPLANIX MARINE POSMV VER. 4.0.
 4. GRID COORDINATES ARE BASED ON THE MICHIGAN STATE PLANE COORDINATE SYSTEM, LAMBERT PROJECTION, MICHIGAN NORTH ZONE (111), NORTH AMERICAN DATUM (NAD83). ALL COORDINATES SHOWN ARE IN U.S. SURVEY FEET.
 5. THE PROJECT DEPTH FOR THIS AREA IS 25'.

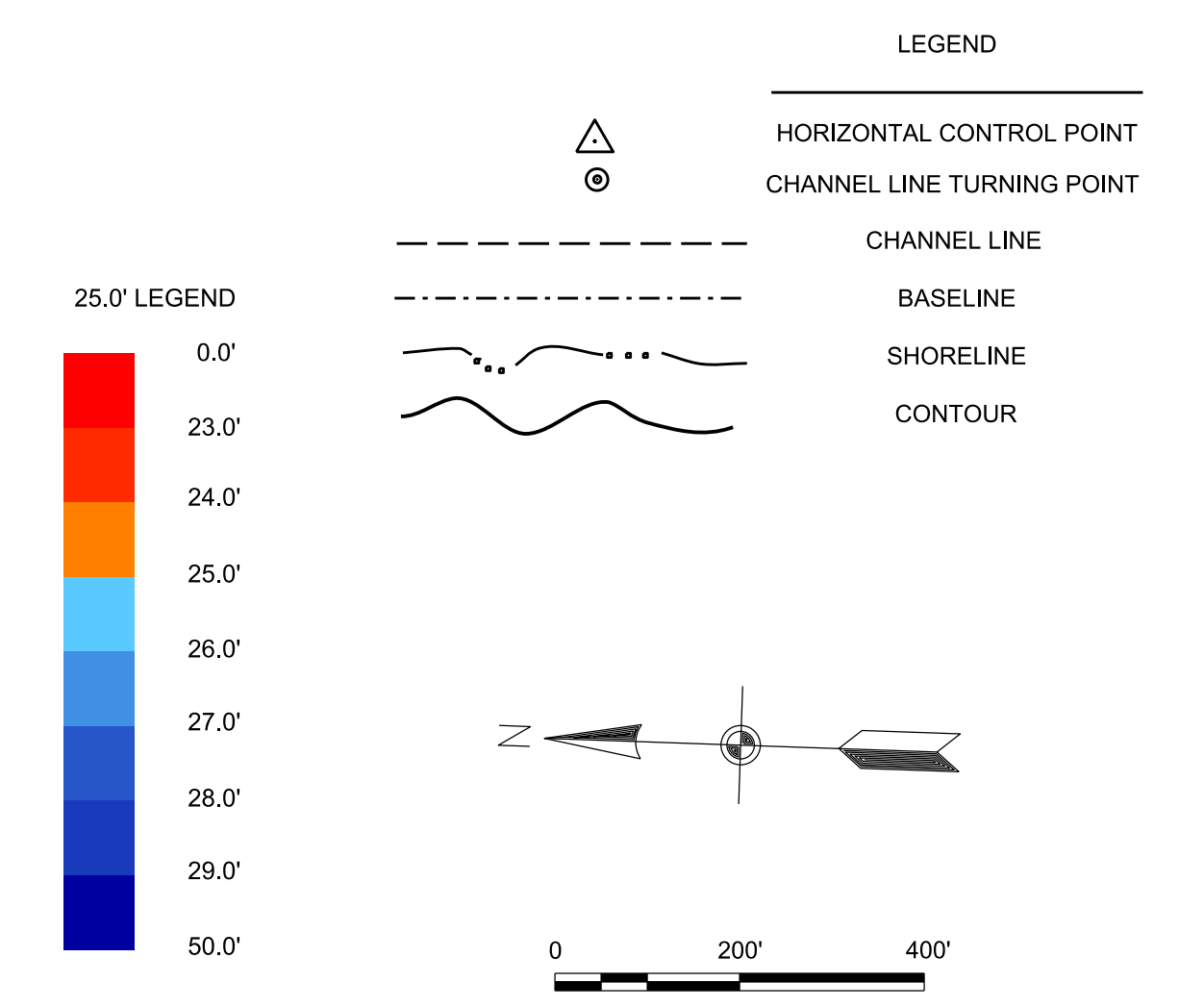

COORDINATE TABLE

STATION	DESCRIPTION	NORTHING	EASTING
OSKAR	ALUM. CAP.	875361.828	258375816.75
OVERLOOK	BRASS CAP.	871444.161	25839382.862
PAAVOLA	ALUM. CAP.	876314.391	25840286.617
SPONGE	ALUM. CAP.	877888.898	25839878.431
RED. LT #68	NAVIC. AD.	888418.653	25844436.963
CENTER LT	NAVIC. AD.	882688.654	25844190.110
PT. 27	E. CHANNEL LINE	881476.6	25843545.0
PT. 29	E. CHANNEL LINE	879379.3	25839322.3
PT. 31	F. CHANNEL LINE	875210.6	25839321.4
PT. 33	F. CHANNEL LINE	874457.0	25839321.0
PT. 35	F. CHANNEL LINE	873686.2	25838848.0
PT. 37	F. CHANNEL LINE	872833.2	25839233.8
PT. 39	F. CHANNEL LINE	872011.4	25840782.0
PT. D	CENTERLINE	885445.8	25844212.3
PT. E	CENTERLINE	885460.3	25843412.2
PT. F	CENTERLINE	874581.8	25838852.2
PT. G	CENTERLINE	872475.8	25838971.6
PT. H	CENTERLINE	872411.3	25840888.2
PT. 30	W. CHANNEL LINE	881131.8	25842546.7
PT. 32	W. CHANNEL LINE	878149.8	25840888.2
PT. 34	W. CHANNEL LINE	876438.0	25838852.3
PT. 36	W. CHANNEL LINE	874615.3	25838383.8
PT. 38	W. CHANNEL LINE	872816.6	25838170.6
PT. 40	W. CHANNEL LINE	870788.8	25840120.3