

LAKE SUPERIOR

AREA 24

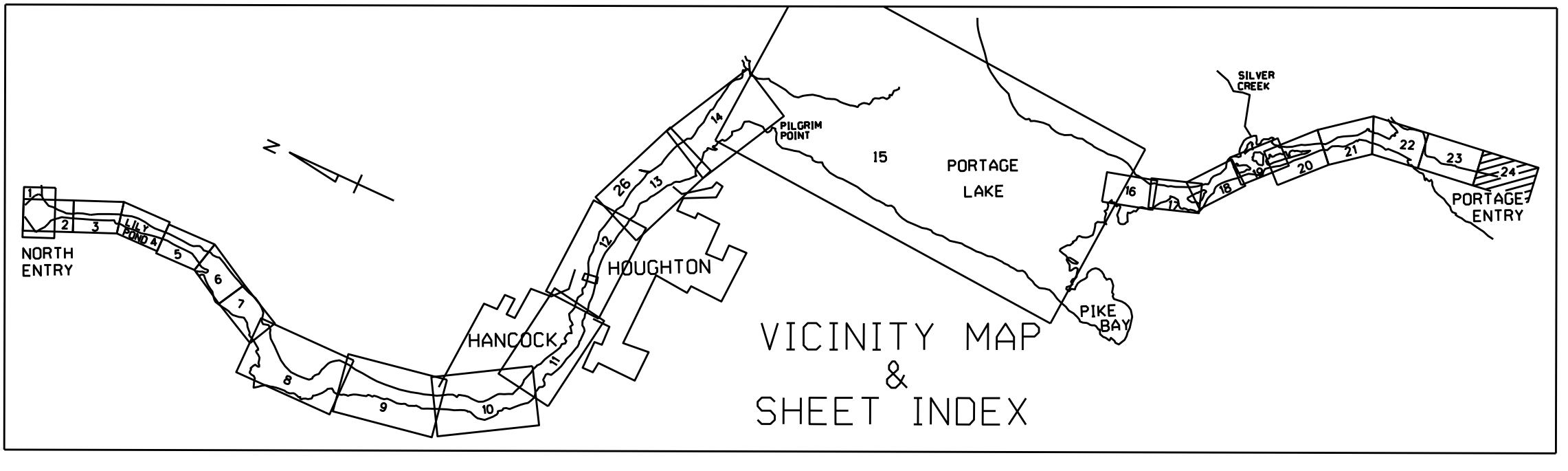

- NOTES
1. THE INFORMATION DEPICTED ON THIS MAP REPRESENTS THE RESULTS OF SURVEYS MADE ON JUNE 05, 2018 AND CAN ONLY BE CONSIDERED AS INDICATING THE GENERAL CONDITIONS PRESENT AT THE TIME.
 2. SOUNDING DEPTHS ARE REFERENCED TO INTERNATIONAL GREAT LAKES DATUM 1985 (IGLD 85) LOW WATER DATUM (LWD) ELEVATION IS 601.1 FEET ABOVE MEAN WATER LEVEL AT RIMOUSQUÉ, QUEBEC. WATER LEVEL READINGS WERE OBTAINED WITH RTK GPS VALUES. DEPTHS ARE MEASURED USING A ROSS 8258 SINGLE BEAM DEPTH SOUNDER.
 3. HORIZONTAL POSITIONING IS DETERMINED USING REAL TIME KINEMATIC (RTK) GLOBAL NAVIGATION SATELLITE SYSTEM (GNSS) CORRECTIONS FROM A BASE STATION LOCATED AT US ARMY CORPS OF ENGINEERS (USACE) CONTROL POINT 153, A PK NAIL SET IN THE CONCRETE AT THE NORTH EAST SIDE OF A DOCK WALL AT KEWEENAW PARK ON NORTH ENTRY ROAD, NORTHERLY OF THE NORTHERN MOST SOLLARD. THE GPS RECEIVER IS MANUFACTURED BY APPLANIX MARINE POS/MV, VER. 4.0.
 4. GRID COORDINATES ARE BASED ON THE MICHIGAN STATE PLANE COORDINATE SYSTEM, LAMBERT PROJECTION, MICHIGAN NORTH ZONE (2111), NORTH AMERICAN DATUM (NAD83). ALL COORDINATES SHOWN ARE IN U.S. SURVEY FEET.
 5. THE PROJECT DEPTHS FOR THIS AREA ARE 26', 27', AND 28'.

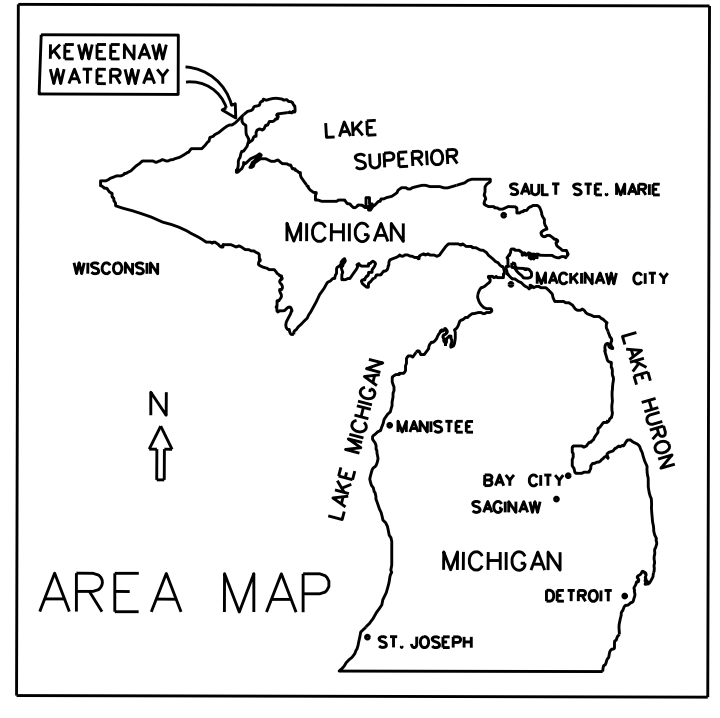
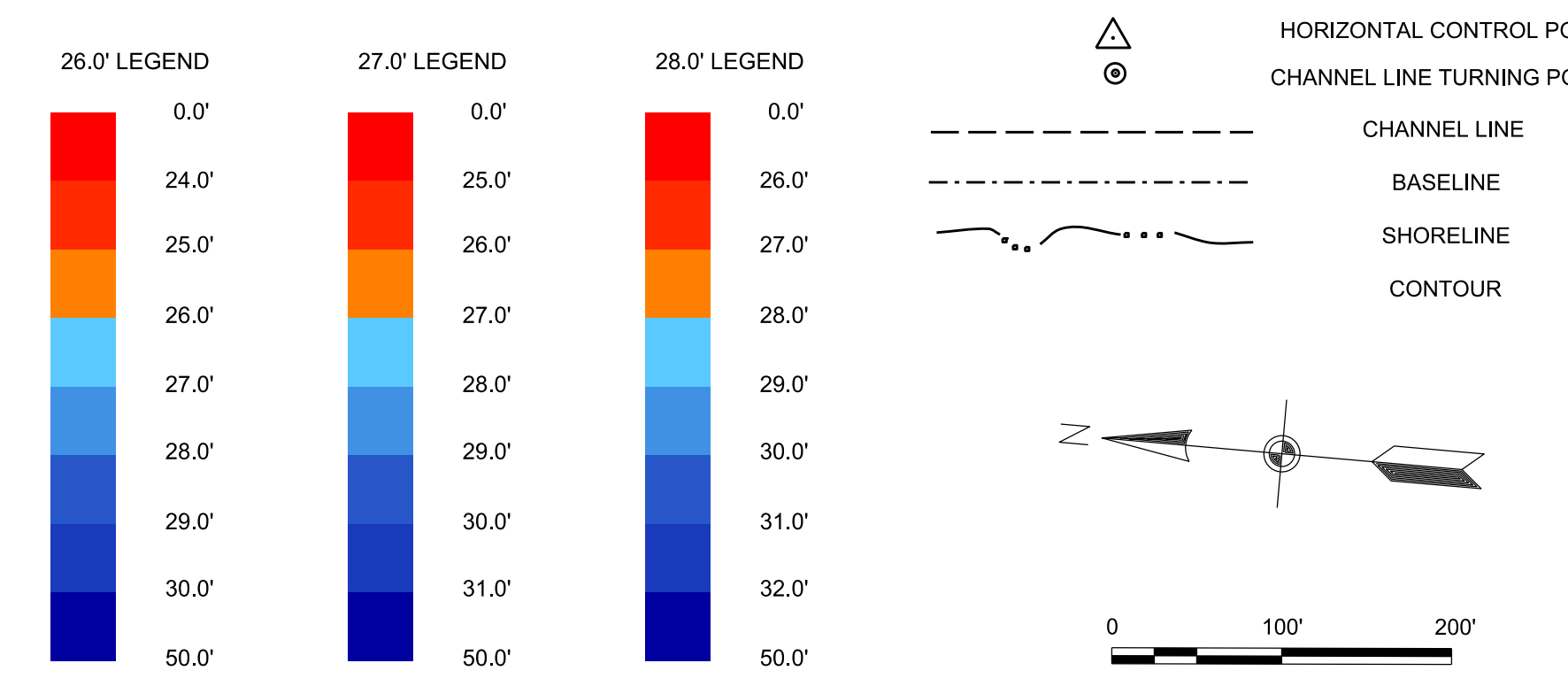

COORDINATE TABLE

STATION	DESCRIPTION	COORDINATES	
		NORTHING	EASTING
MON_98	BRASS DISC	802653.8	2588326.6
LHTS#2	NAVIC AID	800174.831	2588376.678
PT_98	E. CHANNEL LINE	802653.8	2588326.6
PT_99	E. CHANNEL LINE	802653.8	2588326.6
PT_97	E. CHANNEL LINE	802653.8	2588326.6
PT_96	E. CHANNEL LINE	802653.8	2588326.6
PT_95	E. CHANNEL LINE	802653.8	2588326.6
PT_94	E. CHANNEL LINE	802653.8	2588326.6
PT_93	E. CHANNEL LINE	802653.8	2588326.6
PT_92	E. CHANNEL LINE	802653.8	2588326.6
PT_91	E. CHANNEL LINE	802653.8	2588326.6
PT_90	E. CHANNEL LINE	802653.8	2588326.6
PT_89	E. CHANNEL LINE	802653.8	2588326.6
PT_88	E. CHANNEL LINE	802653.8	2588326.6
PT_87	E. CHANNEL LINE	802653.8	2588326.6
PT_86	E. CHANNEL LINE	802653.8	2588326.6
PT_85	E. CHANNEL LINE	802653.8	2588326.6
PT_84	E. CHANNEL LINE	802653.8	2588326.6
PT_83	E. CHANNEL LINE	802653.8	2588326.6
PT_82	E. CHANNEL LINE	802653.8	2588326.6
PT_81	E. CHANNEL LINE	802653.8	2588326.6
PT_80	E. CHANNEL LINE	802653.8	2588326.6
PT_79	E. CHANNEL LINE	802653.8	2588326.6
PT_78	E. CHANNEL LINE	802653.8	2588326.6
PT_77	E. CHANNEL LINE	802653.8	2588326.6
PT_76	E. CHANNEL LINE	802653.8	2588326.6
PT_75	E. CHANNEL LINE	802653.8	2588326.6
PT_74	E. CHANNEL LINE	802653.8	2588326.6
PT_73	E. CHANNEL LINE	802653.8	2588326.6
PT_72	E. CHANNEL LINE	802653.8	2588326.6
PT_71	E. CHANNEL LINE	802653.8	2588326.6
PT_70	E. CHANNEL LINE	802653.8	2588326.6
PT_69	E. CHANNEL LINE	802653.8	2588326.6
PT_68	E. CHANNEL LINE	802653.8	2588326.6
PT_67	E. CHANNEL LINE	802653.8	2588326.6
PT_66	E. CHANNEL LINE	802653.8	2588326.6
PT_65	E. CHANNEL LINE	802653.8	2588326.6
PT_64	E. CHANNEL LINE	802653.8	2588326.6
PT_63	E. CHANNEL LINE	802653.8	2588326.6
PT_62	E. CHANNEL LINE	802653.8	2588326.6
PT_61	E. CHANNEL LINE	802653.8	2588326.6
PT_60	E. CHANNEL LINE	802653.8	2588326.6
PT_59	E. CHANNEL LINE	802653.8	2588326.6
PT_58	E. CHANNEL LINE	802653.8	2588326.6
PT_57	E. CHANNEL LINE	802653.8	2588326.6
PT_56	E. CHANNEL LINE	802653.8	2588326.6
PT_55	E. CHANNEL LINE	802653.8	2588326.6
PT_54	E. CHANNEL LINE	802653.8	2588326.6
PT_53	E. CHANNEL LINE	802653.8	2588326.6
PT_52	E. CHANNEL LINE	802653.8	2588326.6
PT_51	E. CHANNEL LINE	802653.8	2588326.6
PT_50	E. CHANNEL LINE	802653.8	2588326.6
PT_49	E. CHANNEL LINE	802653.8	2588326.6
PT_48	E. CHANNEL LINE	802653.8	2588326.6
PT_47	E. CHANNEL LINE	802653.8	2588326.6
PT_46	E. CHANNEL LINE	802653.8	2588326.6
PT_45	E. CHANNEL LINE	802653.8	2588326.6
PT_44	E. CHANNEL LINE	802653.8	2588326.6
PT_43	E. CHANNEL LINE	802653.8	2588326.6
PT_42	E. CHANNEL LINE	802653.8	2588326.6
PT_41	E. CHANNEL LINE	802653.8	2588326.6
PT_40	E. CHANNEL LINE	802653.8	2588326.6
PT_39	E. CHANNEL LINE	802653.8	2588326.6
PT_38	E. CHANNEL LINE	802653.8	2588326.6
PT_37	E. CHANNEL LINE	802653.8	2588326.6
PT_36	E. CHANNEL LINE	802653.8	2588326.6
PT_35	E. CHANNEL LINE	802653.8	2588326.6
PT_34	E. CHANNEL LINE	802653.8	2588326.6
PT_33	E. CHANNEL LINE	802653.8	2588326.6
PT_32	E. CHANNEL LINE	802653.8	2588326.6
PT_31	E. CHANNEL LINE	802653.8	2588326.6
PT_30	E. CHANNEL LINE	802653.8	2588326.6
PT_29	E. CHANNEL LINE	802653.8	2588326.6
PT_28	E. CHANNEL LINE	802653.8	2588326.6
PT_27	E. CHANNEL LINE	802653.8	2588326.6
PT_26	E. CHANNEL LINE	802653.8	2588326.6
PT_25	E. CHANNEL LINE	802653.8	2588326.6
PT_24	E. CHANNEL LINE	802653.8	2588326.6
PT_23	E. CHANNEL LINE	802653.8	2588326.6
PT_22	E. CHANNEL LINE	802653.8	2588326.6
PT_21	E. CHANNEL LINE	802653.8	2588326.6
PT_20	E. CHANNEL LINE	802653.8	2588326.6
PT_19	E. CHANNEL LINE	802653.8	2588326.6
PT_18	E. CHANNEL LINE	802653.8	2588326.6
PT_17	E. CHANNEL LINE	802653.8	2588326.6
PT_16	E. CHANNEL LINE	802653.8	2588326.6
PT_15	E. CHANNEL LINE	802653.8	2588326.6
PT_14	E. CHANNEL LINE	802653.8	2588326.6
PT_13	E. CHANNEL LINE	802653.8	2588326.6
PT_12	E. CHANNEL LINE	802653.8	2588326.6
PT_11	E. CHANNEL LINE	802653.8	2588326.6
PT_10	E. CHANNEL LINE	802653.8	2588326.6
PT_9	E. CHANNEL LINE	802653.8	2588326.6
PT_8	E. CHANNEL LINE	802653.8	2588326.6
PT_7	E. CHANNEL LINE	802653.8	2588326.6
PT_6	E. CHANNEL LINE	802653.8	2588326.6
PT_5	E. CHANNEL LINE	802653.8	2588326.6
PT_4	E. CHANNEL LINE	802653.8	2588326.6
PT_3	E. CHANNEL LINE	802653.8	2588326.6
PT_2	E. CHANNEL LINE	802653.8	2588326.6
PT_1	E. CHANNEL LINE	802653.8	2588326.6

US Army Corps of Engineers

KEWEENAW WATERWAY
MICHIGAN

CONDITION OF CHANNEL
JUNE 2018

SHEET IDENTIFICATION
KWW 24

DATE: 06/05/2018

TIME: 10:00 AM

PROJECT: KWW 24

SCALE: 1" = 100'

IMAGE SOURCE: FIELD SURVEY

FILE NAME: KWW24_001.dwg

APPROVED BY: [Signature]

APPROVED DATE: 06/05/2018

CONTRACT NO.: [Blank]

PROJECT NO.: [Blank]

DATE: [Blank]

DESCRIPTION: [Blank]

DATE: [Blank]

DESCRIPTION: [Blank]

DATE: [Blank]

DESCRIPTION: [Blank]

DATE: [Blank]

DESCRIPTION: [Blank]