

PROJECT DEPTH 27.5 FT.

LWD 5723

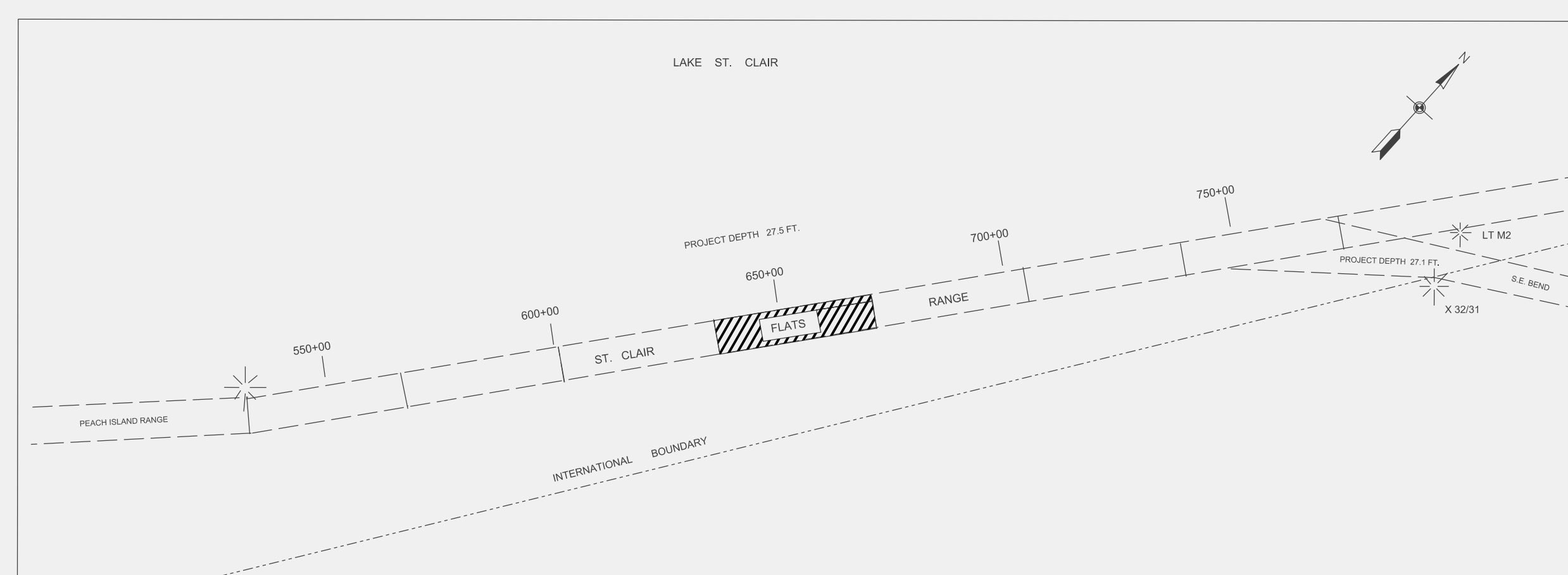
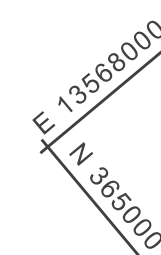
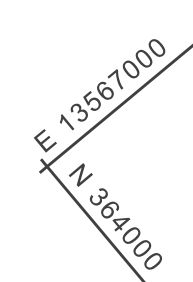
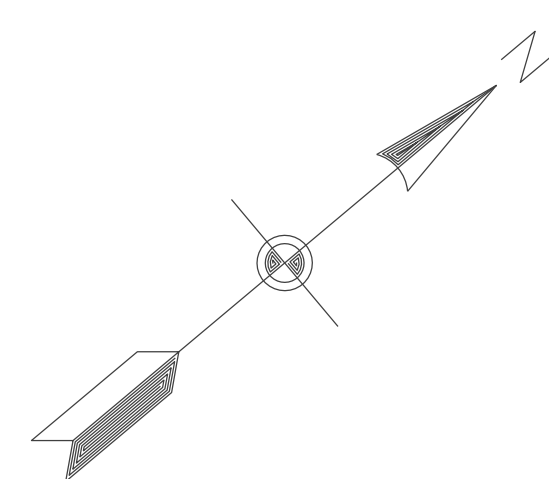

1. THE SOUNDINGS INDICATED HEREON ARE GENERALIZED DEPTHS AND ARE NOT REPRESENTATIVE OF THE FULL DATASET. THE SOUNDINGS REPRESENT THE MINIMUM DEPTH FOUND WITHIN THE 10 FOOT BY 10 FOOT AREA CENTERED ON THE TEXT, DERIVED FROM A 1 FOOT BY 1 FOOT AVERAGE DATASET AT CELL CENTER. THIS MAP SHOULD NOT BE USED FOR CHANNEL CLEARANCE OR VOLUME COMPUTATIONS. MINIMUM DEPTH DATA IS PRODUCED FOR STRIKE/SOAL REMOVAL OPERATIONS AND NOTICES TO NAVIGATION INTERESTS.

2. TIDE VALUES USED WERE OBTAINED FROM THE NOAA GAGE "ST CLAIR SHORES" (#9034052) AND REFERENCE TO IGLD OF 1985. LOW WATER DATUM = 569.2.

3. THE SOUNDINGS AND ASSOCIATED INFORMATION REPRESENTED HEREIN ARE THE RESULT OF SURVEYS MADE ON THE DATE AS INDICATED AND CAN ONLY BE CONSIDERED REPRESENTATIVE OF THE GENERAL CONDITIONS EXISTING AT THE TIME OF SURVEY.

4. THE SOUNDINGS DEPICTED HEREIN ARE EXPRESSED IN U.S. SURVEY FEET AND TENTHS THEREOF AND ARE REFERENCED TO THE FOLLOWING DATUMS:

HORIZONTAL: MICHIGAN STATE PLANE COORDINATE SYSTEM, MICHIGAN SOUTH ZONE #2113,
NORTH AMERICAN DATUM (NAD) OF 1983.

VERTICAL: INTERNATIONAL GREAT LAKES DATUM (IGLD) OF 1985.
LWD = 572.3'

5. THE SURVEY WAS CONDUCTED USING THE U.S.A.C.E. SURVEY VESSEL WHEELER, EMPLOYING THE FOLLOWING COMPONENTS:

POSITIONING: APPLANIX POS-M/V
CORRECTIONS: VRS/RTK or MARINESTAR GPS/VBS
SONAR: R2SONIC 2024 MULTIBEAM
SOFTWARE: HYPACK 2018

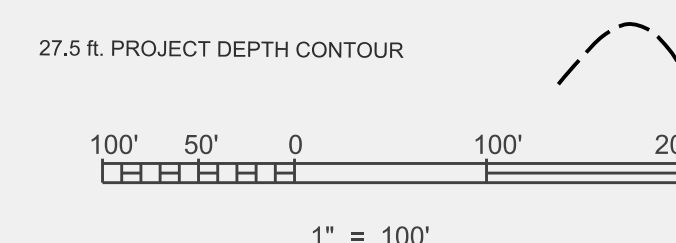
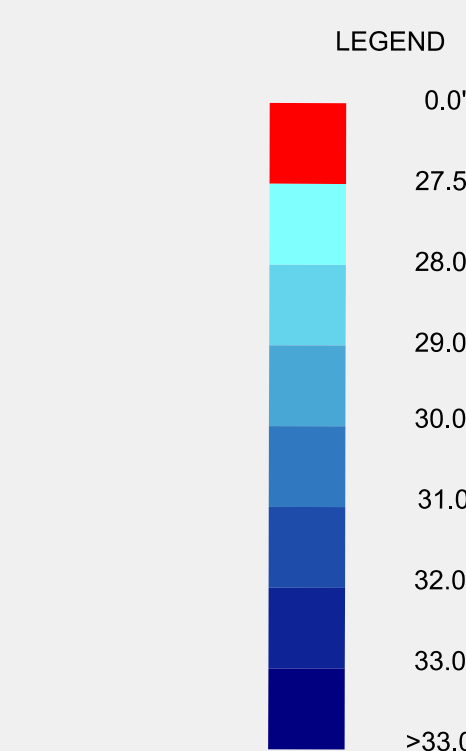

6666 ST. CLAIR FLATS RANGE
LAKE ST. CLAIR, MICHIGAN

CONDITION SURVEY
11 MAY 2019

SHEET
IDENTIFICATION