



N 404.000

N 403.000

N 402.000

E 13.540.000

E 13.541.000

E 13.541.000

E 13.542.000

E 13.542.000

E 13.543.000

E 13.543.000

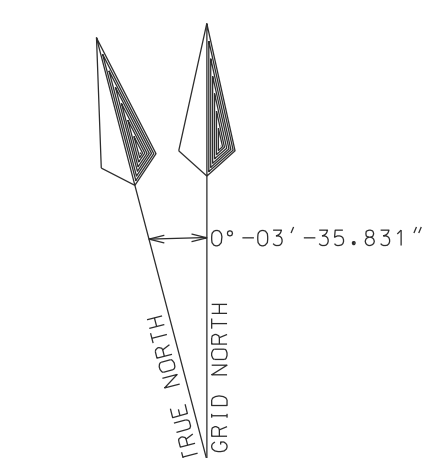

GRID SCALE FACTOR: 0.99991945
GRID DIST. DIVIDED BY GRID SCALE FACTOR = GROUND DIST.

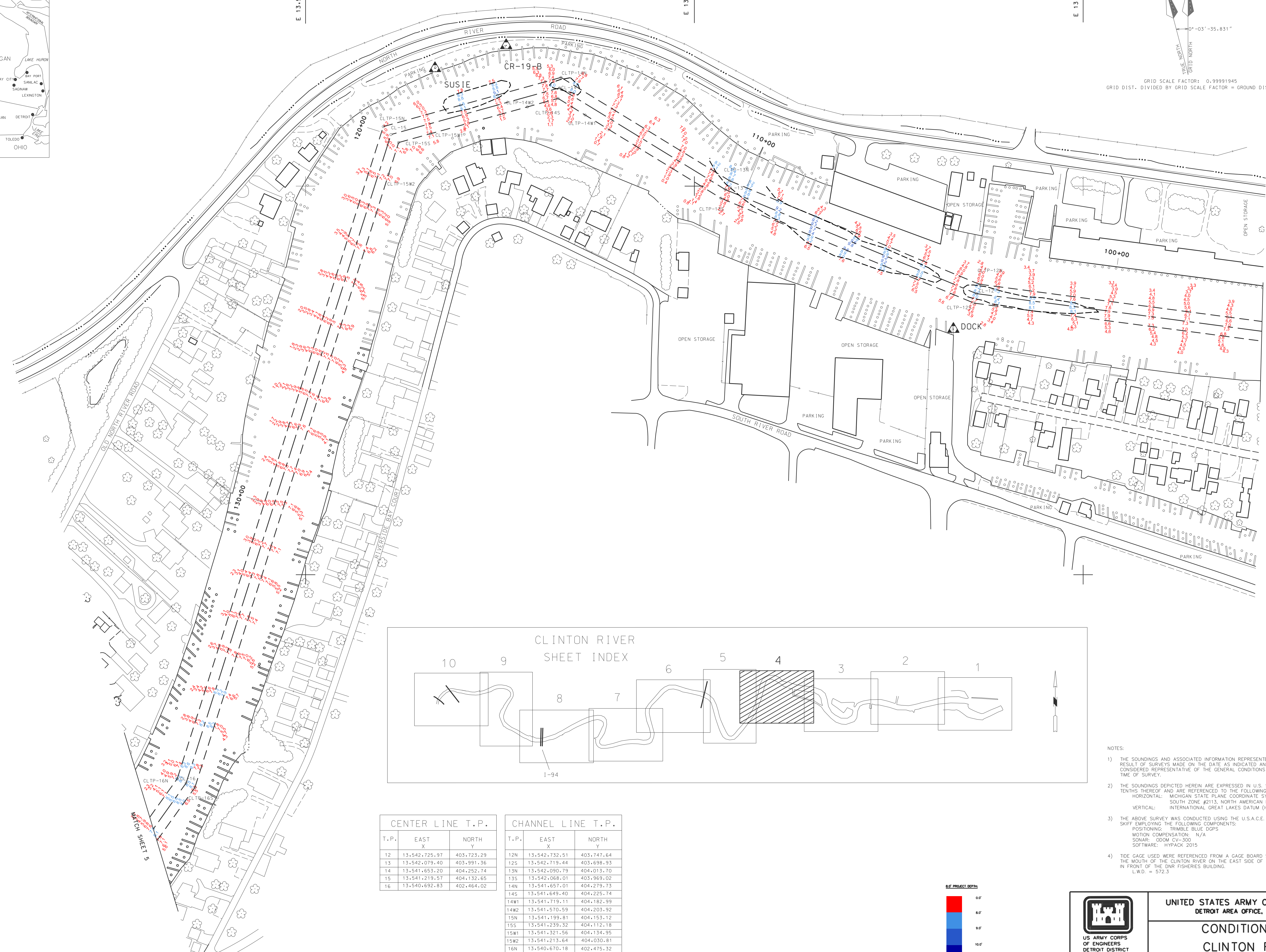

MATCH SHEET 3

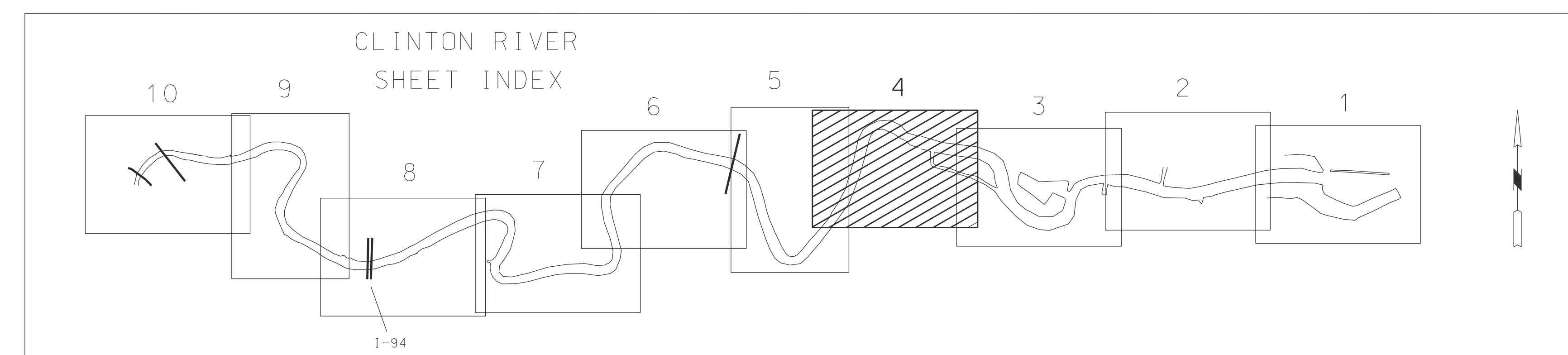

CENTER LINE T.P.			CHANNEL LINE T.P.		
T.P.	EAST X	NORTH Y	T.P.	EAST X	NORTH Y
12	13,542,725.97	403,723.29	12N	13,542,732.51	403,747.64
13	13,542,079.40	403,991.36	12S	13,542,719.44	403,698.93
14	13,541,653.20	404,252.74	13N	13,542,090.79	404,013.70
15	13,541,219.57	404,132.65	13S	13,542,068.01	403,989.02
16	13,540,692.83	402,464.02	14N	13,541,657.01	404,279.73
			14S	13,541,649.40	404,225.74
			14W1	13,541,719.11	404,182.99
			14W2	13,541,570.59	404,203.92
			15N	13,541,199.81	404,153.12
			15S	13,541,239.32	404,112.18
			15W1	13,541,321.56	404,134.95
			15W2	13,541,213.64	404,030.81
			16N	13,540,670.18	402,475.32
			16S	13,540,715.48	402,452.72

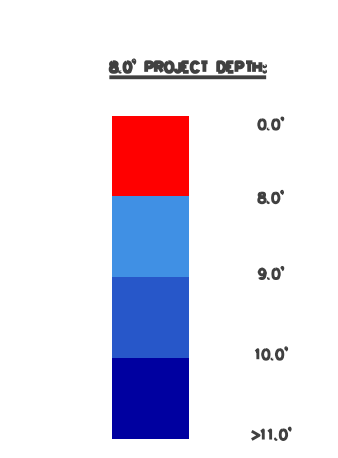

AS PL. PROJECT DEPTH CONTOUR

- NOTES:
- 1) THE SOUNDINGS AND ASSOCIATED INFORMATION REPRESENTED HEREIN ARE THE RESULT OF SURVEYS MADE ON THE DATE AS INDICATED AND CAN ONLY BE CONSIDERED REPRESENTATIVE OF THE GENERAL CONDITIONS EXISTING AT THE TIME OF SURVEY.
 - 2) THE SOUNDINGS DEPICTED HEREIN ARE EXPRESSED IN U.S. SURVEY FEET AND TENTHS THEREOF AND ARE REFERENCED TO THE FOLLOWING DATUMS:
HORIZONTAL: MICHIGAN STATE PLANE COORDINATE SYSTEM, MICHIGAN SOUTH ZONE #2113, NORTH AMERICAN DATUM (NAD) OF 1983.
VERTICAL: INTERNATIONAL GREAT LAKES DATUM (IGLD) OF 1985.
 - 3) THE ABOVE SURVEY WAS CONDUCTED USING THE U.S.A.C.E. SURVEY VESSEL SKIFF EMPLOYING THE FOLLOWING COMPONENTS:
POSITIONING: TRIMBLE BLUE DIPS
MOTION COMPENSATION: N/A
SONAR: ODOM CV-300
SOFTWARE: HYPACK 2015
 - 4) TIDE GAGE USED WERE REFERENCED FROM A GAGE BOARD SET ON PILING NEAR THE MOUTH OF THE CLINTON RIVER ON THE EAST SIDE OF THE DNR DOCK, IN FRONT OF THE DNR FISHERIES BUILDING.
L.W.D. = 572.3

UNITED STATES ARMY CORPS OF ENGINEERS
DETROIT AREA OFFICE, DETROIT, MICHIGAN

CONDITION SURVEY
CLINTON RIVER, MI
CS 96+00W TO CS 139+00W

DRAWN BY: **B.R.**

CHECKED BY: **C.V.L.** DATE OF SURVEY: **16 MAY 2017**

SCALE 1" = 100'

SHEET **4** OF **10**