

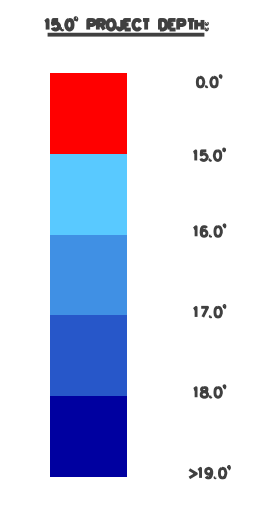

INDEX TO SHEETS
BELLE RIVER

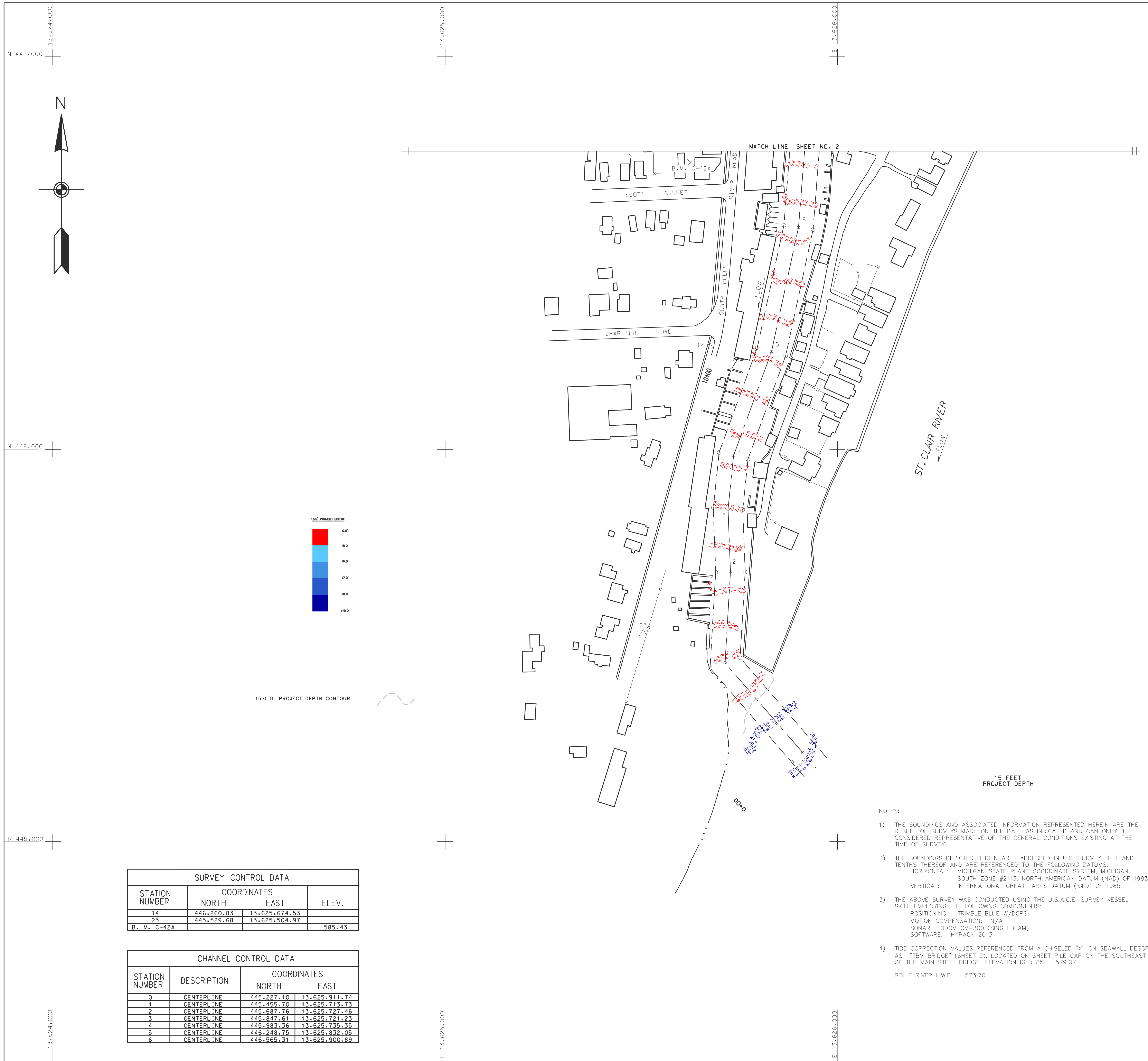
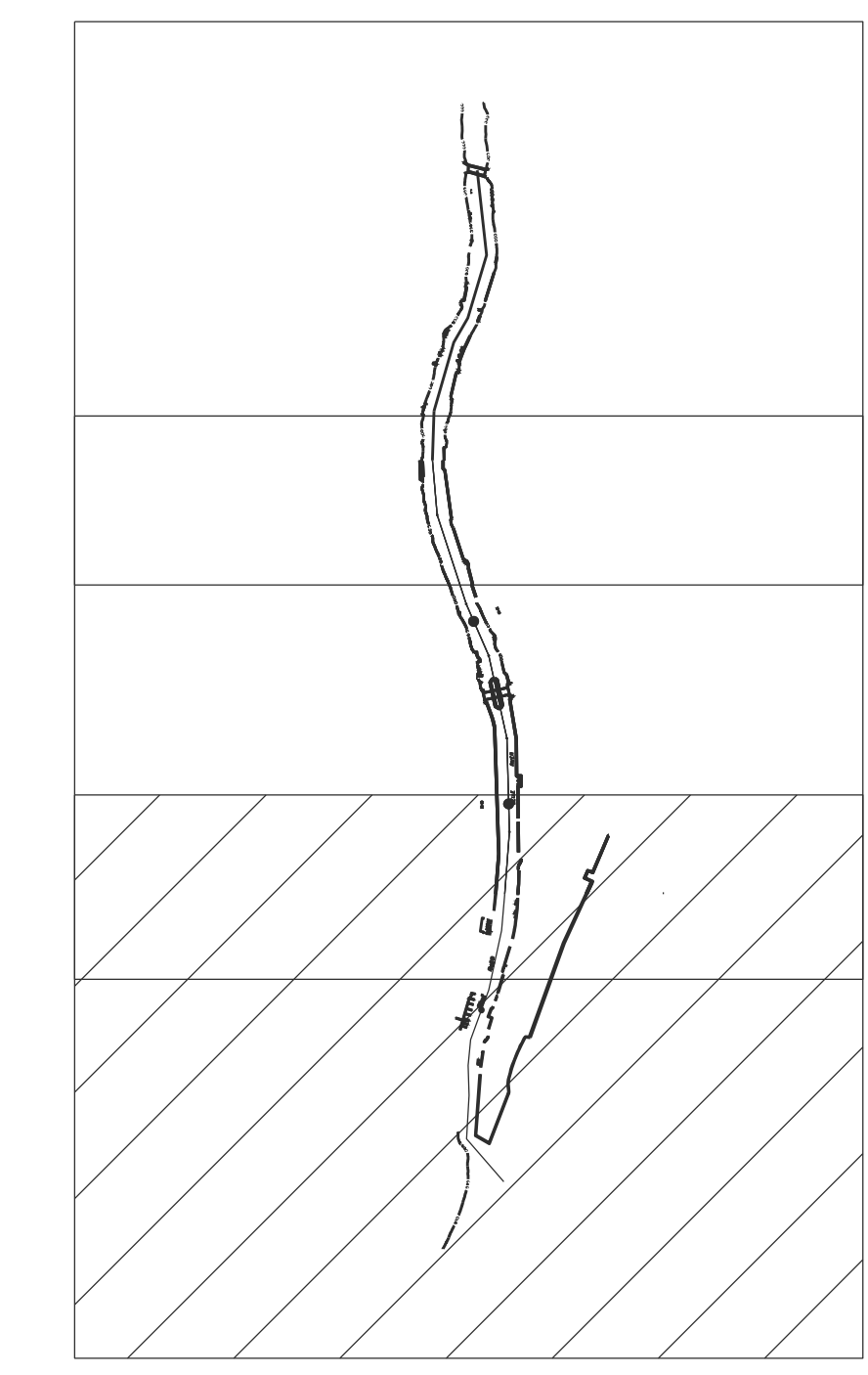

15.0 FT. PROJECT DEPTH CONTOUR

15 FEET
PROJECT DEPTH

SURVEY CONTROL DATA			
STATION NUMBER	COORDINATES		ELEV.
	NORTH	EAST	
14	446,260.83	13,625,674.53	
23	445,529.68	13,625,504.97	
B. M. C-42A			585.43

CHANNEL CONTROL DATA			
STATION NUMBER	DESCRIPTION	COORDINATES	
		NORTH	EAST
0	CENTERLINE	445,227.10	13,625,911.74
1	CENTERLINE	445,455.70	13,625,713.73
2	CENTERLINE	445,687.76	13,625,727.46
3	CENTERLINE	445,847.61	13,625,721.23
4	CENTERLINE	445,983.36	13,625,735.35
5	CENTERLINE	446,246.75	13,625,832.05
6	CENTERLINE	446,565.31	13,625,900.89

- NOTES:
- 1) THE SOUNDINGS AND ASSOCIATED INFORMATION REPRESENTED HEREIN ARE THE RESULT OF SURVEYS MADE ON THE DATE AS INDICATED AND CAN ONLY BE CONSIDERED REPRESENTATIVE OF THE GENERAL CONDITIONS EXISTING AT THE TIME OF SURVEY.
 - 2) THE SOUNDINGS DEPICTED HEREIN ARE EXPRESSED IN U.S. SURVEY FEET AND TENTHS THEREOF AND ARE REFERENCED TO THE FOLLOWING DATUMS:
HORIZONTAL: MICHIGAN STATE PLANE COORDINATE SYSTEM, MICHIGAN SOUTH ZONE #2113, NORTH AMERICAN DATUM (NAD) OF 1983.
VERTICAL: INTERNATIONAL GREAT LAKES DATUM (IGLD) OF 1985.
 - 3) THE ABOVE SURVEY WAS CONDUCTED USING THE U.S.A.C.E. SURVEY VESSEL SKIFF EMPLOYING THE FOLLOWING COMPONENTS:
POSITIONING: TRIMBLE BLUE W/DGPS
MOTION COMPENSATION: N/A
SONAR: ODOM CV-300 (SINGLEBEAM)
SOFTWARE: HYDRACK 2013
 - 4) TIDE CORRECTION VALUES REFERENCED FROM A CHISELED "X" ON SEAWALL DESCRIBED AS "TBM BRIDGE" (SHEET 2), LOCATED ON SHEET PILE CAP ON THE SOUTHEAST SIDE OF THE MAIN STEEL BRIDGE, ELEVATION IGLD 85 = 579.07.
BELLE RIVER L.W.D. = 573.70

 US ARMY CORPS OF ENGINEERS DETROIT DISTRICT	UNITED STATES ARMY CORPS OF ENGINEERS DETROIT AREA OFFICE, DETROIT, MICHIGAN
	CONDITION SURVEY BELLE RIVER, MI CS 00+00 TO CS 16+00
DRAWN BY: B.R.	DATE OF SURVEY: 22 SEPT 2017
CHECKED BY: C.V.L.	
SHEET 1 OF 3	

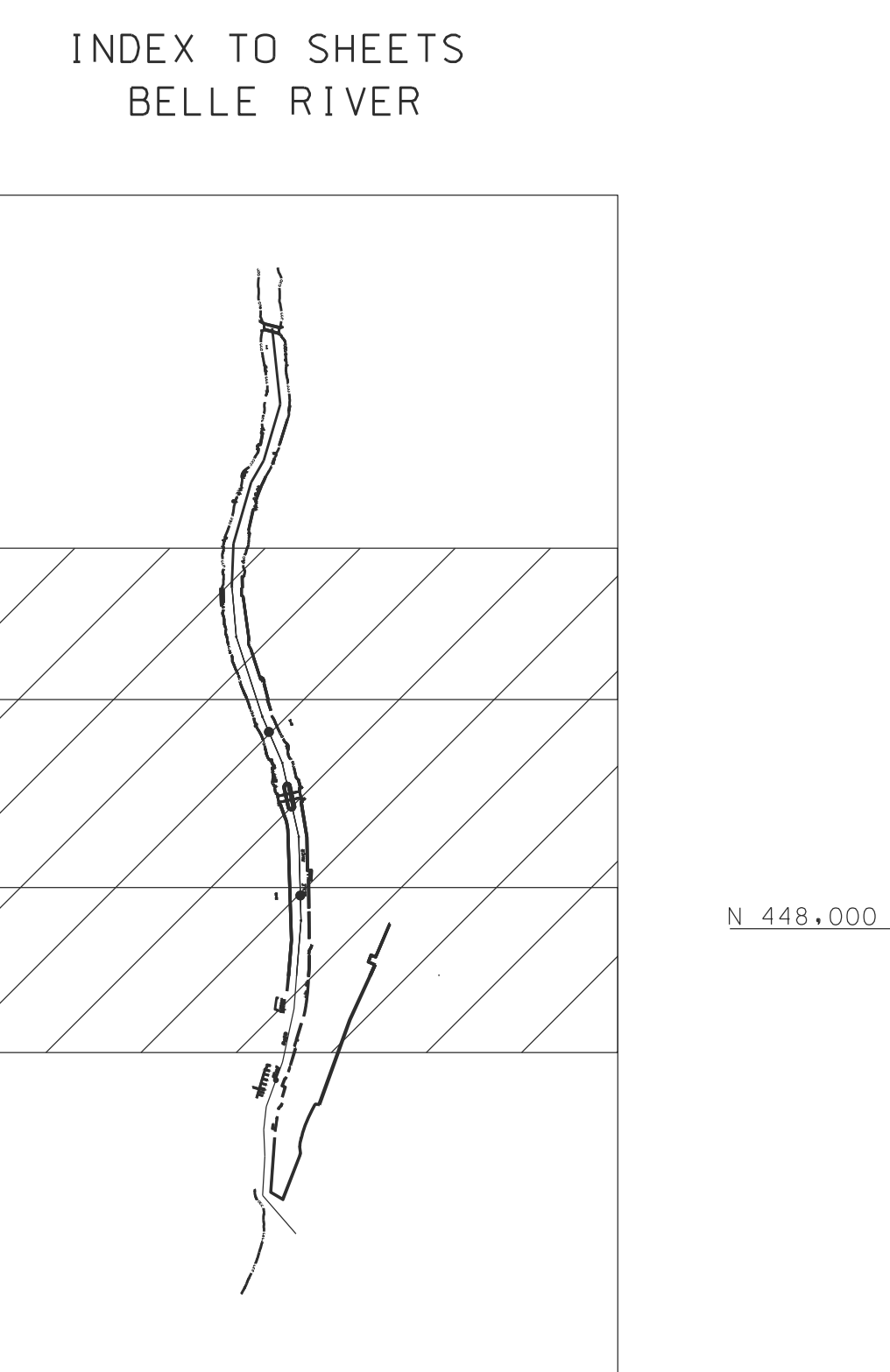
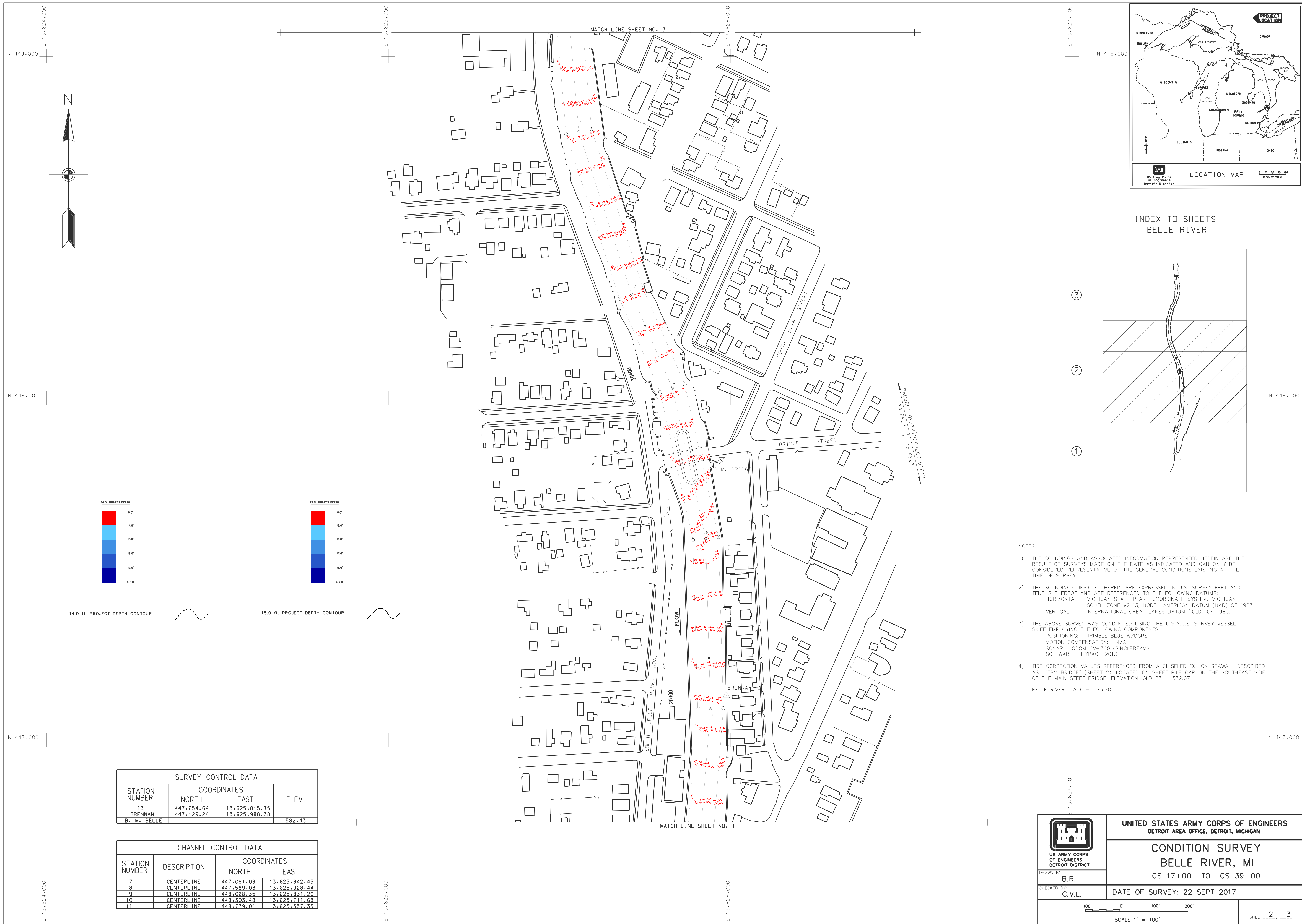

14.0 ft. PROJECT DEPTH CONTOUR 15.0 ft. PROJECT DEPTH CONTOUR

SURVEY CONTROL DATA			
STATION NUMBER	COORDINATES		ELEV.
	NORTH	EAST	
3	447.654.64	13.625.815.75	
BRENNAN	447.125.24	13.625.988.38	
B. M. BELLE			582.43

CHANNEL CONTROL DATA			
STATION NUMBER	DESCRIPTION	COORDINATES	
		NORTH	EAST
7	CENTERLINE	447.091.09	13.625.942.45
8	CENTERLINE	447.589.03	13.625.928.44
9	CENTERLINE	448.028.35	13.625.831.20
10	CENTERLINE	448.303.48	13.625.711.68
11	CENTERLINE	448.779.01	13.625.557.35

- NOTES:
- 1) THE SOUNDINGS AND ASSOCIATED INFORMATION REPRESENTED HEREIN ARE THE RESULT OF SURVEYS MADE ON THE DATE AS INDICATED AND CAN ONLY BE CONSIDERED REPRESENTATIVE OF THE GENERAL CONDITIONS EXISTING AT THE TIME OF SURVEY.
 - 2) THE SOUNDINGS DEPICTED HEREIN ARE EXPRESSED IN U.S. SURVEY FEET AND TENTHS THEREOF AND ARE REFERENCED TO THE FOLLOWING DATUMS:
 HORIZONTAL: MICHIGAN STATE PLANE COORDINATE SYSTEM, MICHIGAN SOUTH ZONE #2113, NORTH AMERICAN DATUM (NAD) OF 1983.
 VERTICAL: INTERNATIONAL GREAT LAKES DATUM (IGLD) OF 1985.
 - 3) THE ABOVE SURVEY WAS CONDUCTED USING THE U.S.A.C.E. SURVEY VESSEL SKIFF EMPLOYING THE FOLLOWING COMPONENTS:
 POSITIONING: TRIMBLE BLUE W/DGPS
 MOTION COMPENSATION: N/A
 SONAR: ODOM CV-300 (SINGLEBEAM)
 SOFTWARE: HYPACK 2013
 - 4) TIDE CORRECTION VALUES REFERENCED FROM A CHISELED "X" ON SEAWALL DESCRIBED AS "TBM BRIDGE" (SHEET 2), LOCATED ON SHEET PILE CAP ON THE SOUTHEAST SIDE OF THE MAIN STEET BRIDGE. ELEVATION IGLD 85 = 579.07.
 BELLE RIVER L.W.D. = 573.70

	UNITED STATES ARMY CORPS OF ENGINEERS DETROIT AREA OFFICE, DETROIT, MICHIGAN	
	CONDITION SURVEY BELLE RIVER, MI CS 17+00 TO CS 39+00	
DRAWN BY: B.R.	DATE OF SURVEY: 22 SEPT 2017	
CHECKED BY: C.V.L.		
		SHEET 2 OF 3

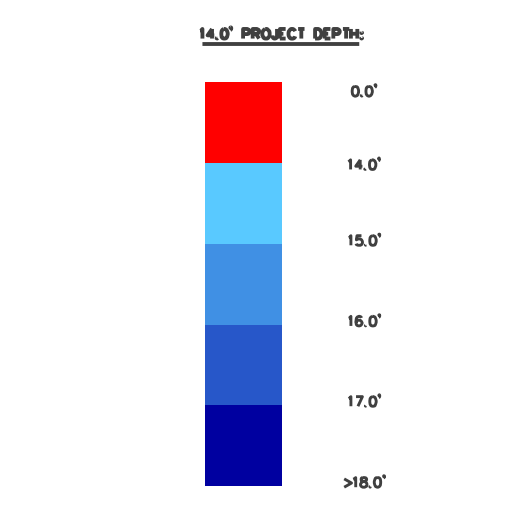
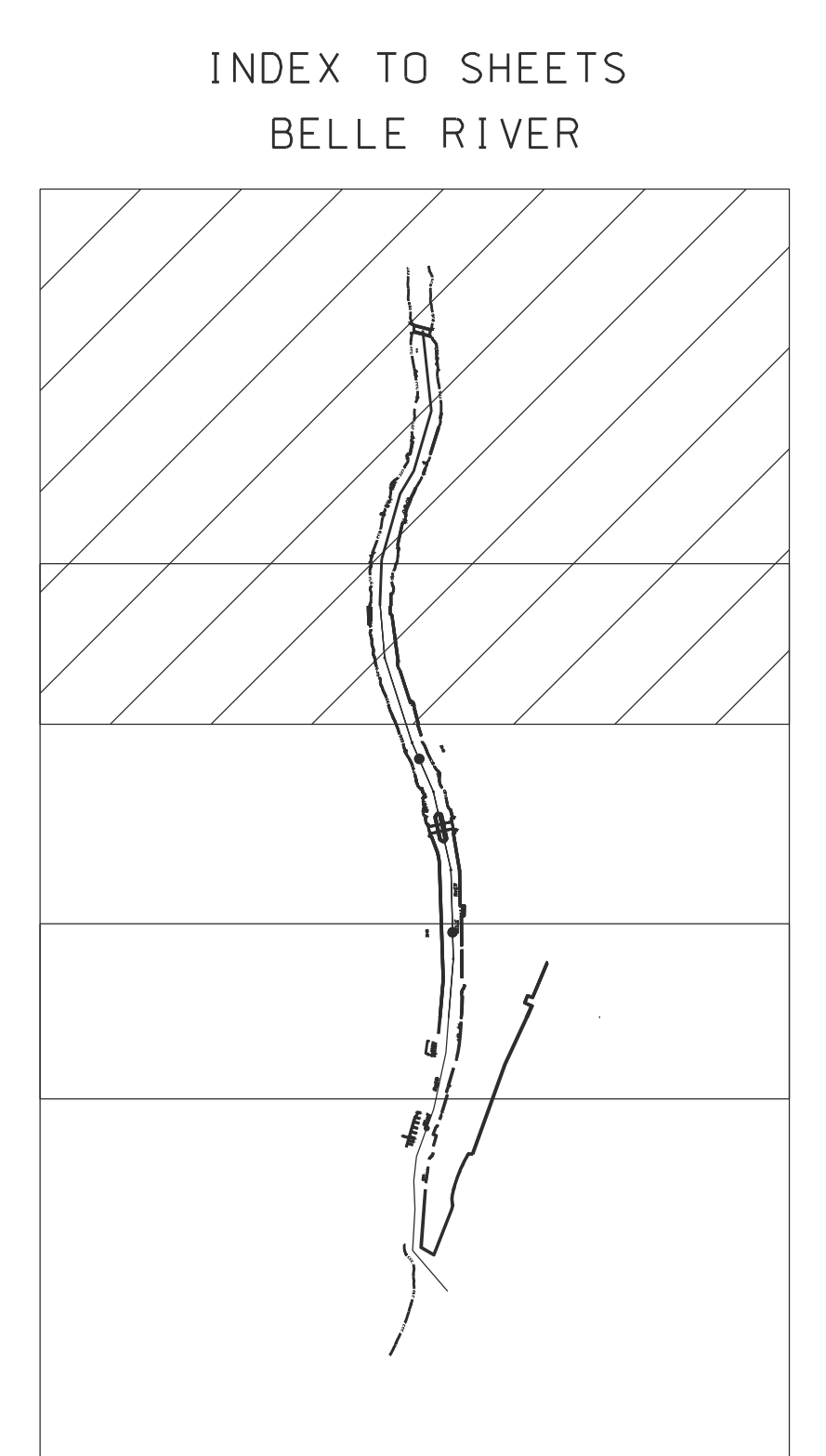
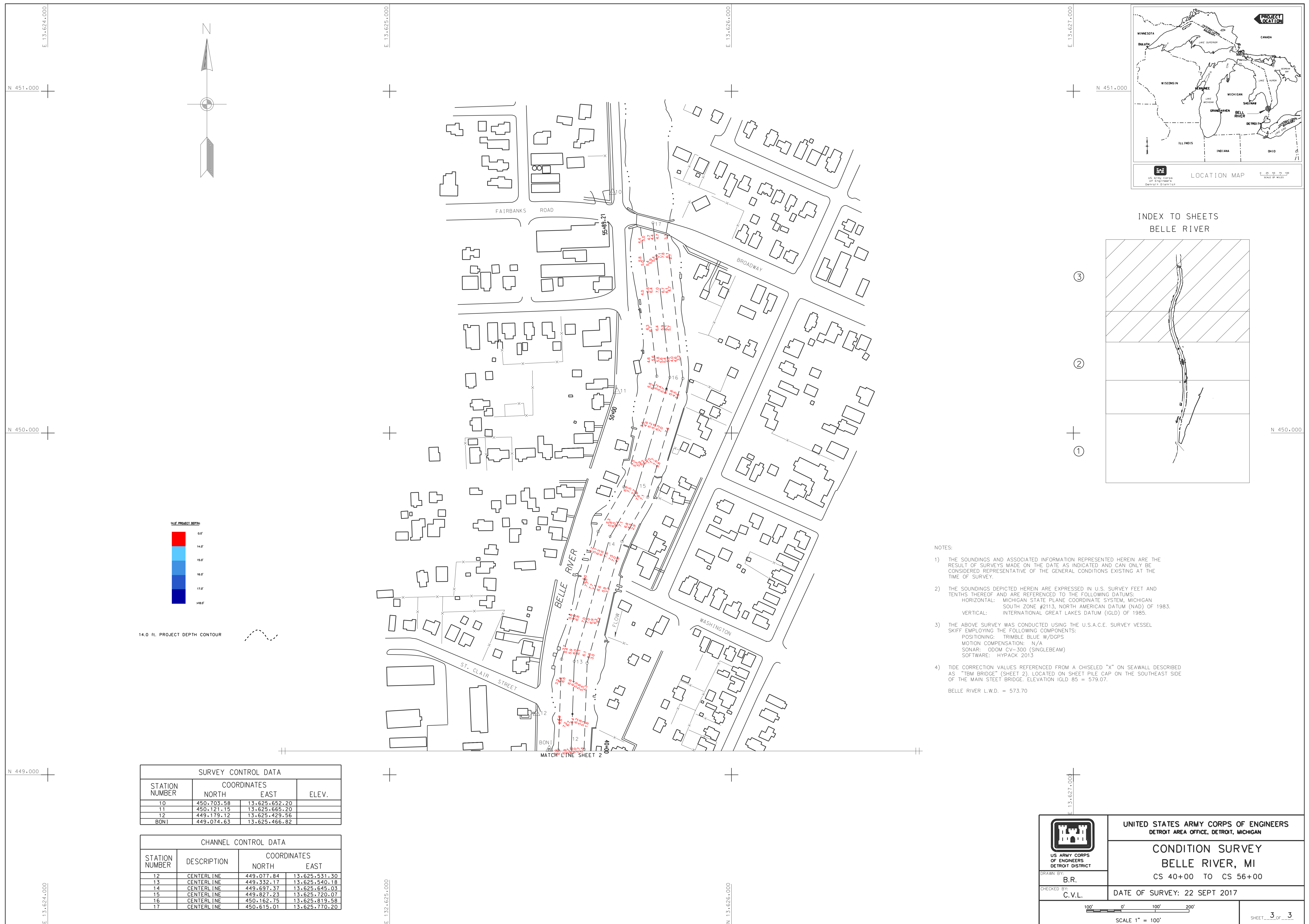

14.0 FT. PROJECT DEPTH CONTOUR

- NOTES:
- 1) THE SOUNDINGS AND ASSOCIATED INFORMATION REPRESENTED HEREIN ARE THE RESULT OF SURVEYS MADE ON THE DATE AS INDICATED AND CAN ONLY BE CONSIDERED REPRESENTATIVE OF THE GENERAL CONDITIONS EXISTING AT THE TIME OF SURVEY.
 - 2) THE SOUNDINGS DEPICTED HEREIN ARE EXPRESSED IN U.S. SURVEY FEET AND TENTHS THEREOF AND ARE REFERENCED TO THE FOLLOWING DATUMS:
 HORIZONTAL: MICHIGAN STATE PLANE COORDINATE SYSTEM, MICHIGAN SOUTH ZONE #2113, NORTH AMERICAN DATUM (NAD) OF 1983.
 VERTICAL: INTERNATIONAL GREAT LAKES DATUM (IGLD) OF 1985.
 - 3) THE ABOVE SURVEY WAS CONDUCTED USING THE U.S.A.C.E. SURVEY VESSEL SKIFF EMPLOYING THE FOLLOWING COMPONENTS:
 POSITIONING: TRIMBLE BLUE W/DGPS
 MOTION COMPENSATION: N/A
 SONAR: ODOM CV-300 (SINGLEBEAM)
 SOFTWARE: HYPACK 2013
 - 4) TIDE CORRECTION VALUES REFERENCED FROM A CHISELED "X" ON SEAWALL DESCRIBED AS "TBM BRIDGE" (SHEET 2), LOCATED ON SHEET PILE CAP ON THE SOUTHEAST SIDE OF THE MAIN STREET BRIDGE. ELEVATION IGLD 85 = 579.07.
 BELLE RIVER L.W.D. = 573.70

SURVEY CONTROL DATA			
STATION NUMBER	COORDINATES		ELEV.
	NORTH	EAST	
10	450.703.58	13.625.652.20	
11	450.121.15	13.625.665.20	
12	449.119.12	13.625.429.56	
BON1	449.074.63	13.625.466.82	

CHANNEL CONTROL DATA			
STATION NUMBER	DESCRIPTION	COORDINATES	
		NORTH	EAST
12	CENTERLINE	449.077.84	13.625.531.30
13	CENTERLINE	449.332.17	13.625.540.18
14	CENTERLINE	449.697.37	13.625.645.03
15	CENTERLINE	449.827.23	13.625.720.07
16	CENTERLINE	450.162.35	13.625.819.58
17	CENTERLINE	450.615.01	13.625.770.20

	UNITED STATES ARMY CORPS OF ENGINEERS DETROIT AREA OFFICE, DETROIT, MICHIGAN	
	CONDITION SURVEY BELLE RIVER, MI CS 40+00 TO CS 56+00	
DRAWN BY: B.R.	DATE OF SURVEY: 22 SEPT 2017	
CHECKED BY: C.V.L.	SCALE 1" = 100'	
		SHEET 3 OF 3