

INDEX TO BRIDGES
SHOWN THUS

- 1 MICHIGAN AVE. BRIDGE
- 2 OHIO ST. BRIDGE
- 3 CONRAIL CORP. BRIDGE
- 4 NORFOLK & WESTERN RAILWAY
- 5 BUFFALO CREEK R.R. BRIDGE
- 6 SOUTH PARK AVE. BRIDGE
- 7 BAILEY AVE. BRIDGE
- 8 OHIO ST. BRIDGE (FIXED)
- 9 FUHRMANN BOULEVARD BRIDGE
- 10 BUFFALO SKYWAY

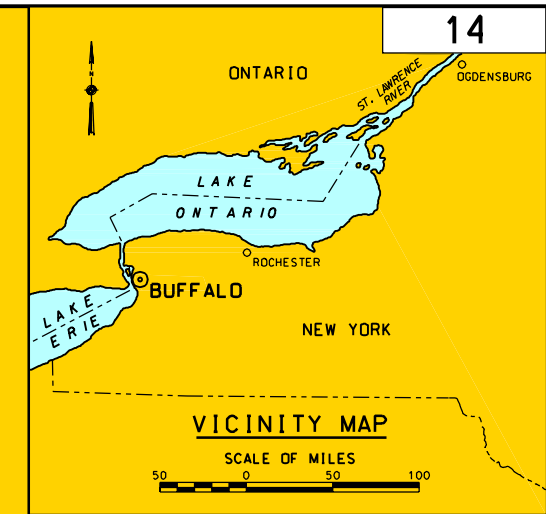

Authorized Federal Channel				
AREA	DEPTH		WIDTH	
	Authorized	Recommended	Authorized	Recommended
1	25	25	800	500
2	30	30	1000	500
3	29	29	500-1000	500
4	28	28	1400	1400
5	28	Not Maintained	1400	Not Maintained
6	27	Not Maintained	500	Not Maintained
7	23	Not Maintained	900	Not Maintained
8	27	Not Maintained	1400	Not Maintained
9	23	23	1400	1400
10	22	22	125-150	125-150
11	22	22	125-150	125-150
12	22	Not Maintained	125-150	Not Maintained

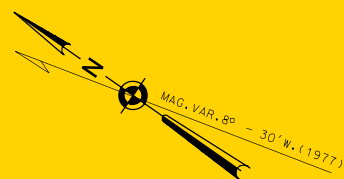
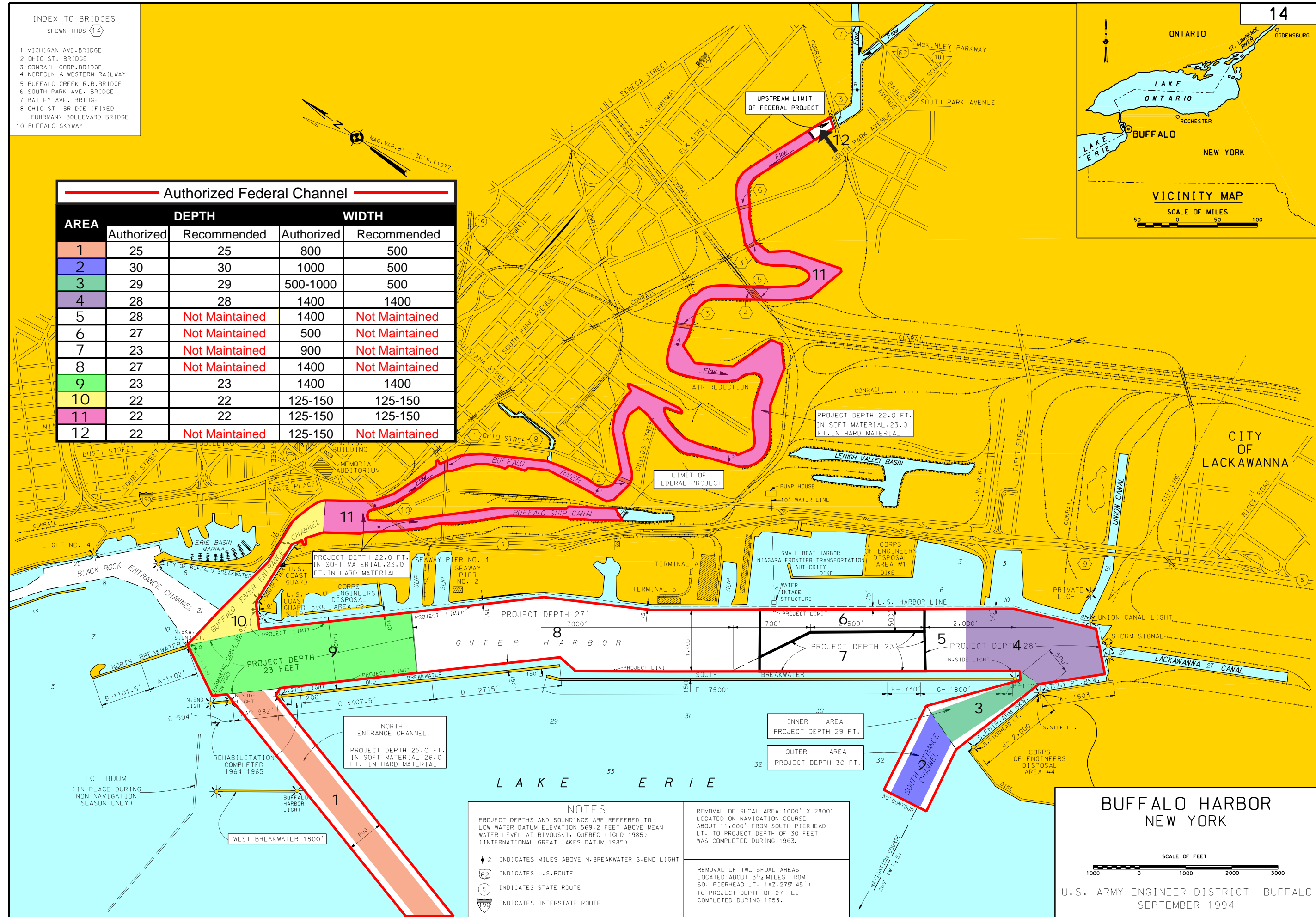

NOTES

PROJECT DEPTHS AND SOUNDINGS ARE REFERRED TO LOW WATER DATUM ELEVATION 569.2 FEET ABOVE MEAN WATER LEVEL AT RIMOUSKI, QUEBEC (IGLD 1985) (INTERNATIONAL GREAT LAKES DATUM 1985)

2 INDICATES MILES ABOVE N. BREAKWATER S. END LIGHT

INDICATES U.S. ROUTE

INDICATES STATE ROUTE

INDICATES INTERSTATE ROUTE

REMOVAL OF SHOAL AREA 1000' X 2800' LOCATED ON NAVIGATION COURSE ABOUT 11,000' FROM SOUTH PIERHEAD LT. TO PROJECT DEPTH OF 30 FEET WAS COMPLETED DURING 1963.

REMOVAL OF TWO SHOAL AREAS LOCATED ABOUT 3 1/4 MILES FROM SO. PIERHEAD LT. (AZ. 275° 45') TO PROJECT DEPTH OF 27 FEET COMPLETED DURING 1953.

**BUFFALO HARBOR
NEW YORK**

SCALE OF FEET
1000 0 1000 2000 3000

U.S. ARMY ENGINEER DISTRICT BUFFALO
SEPTEMBER 1994